

Arctic Cat® OHUV

Installation Instructions - Accessory Kit

Windshield Wiper Kit (Flip-Up Style)

(p/n 1436-073)

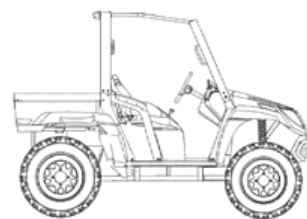

■ **NOTE:** Read these installation instructions thoroughly before beginning the installation process. Retain these Installation Instructions for future reference.

Application

2006 Prowler XT and 2007/2008 Prowler/
Prowler XT

Kit includes:

p/n	QTY	DESCRIPTION
1441-709	1	Wiper Motor (12 Volt)
1441-710	1	Wiper Arm
1441-711	1	Flex Wiper Blade (14 in.)
0486-265	1	Harness w/Fuse
0423-103	1	Fuse (5 AMP)
0423-801	3	Wire-Tie Mount
1441-550	1	Rocker Switch (ON/OFF)
8007-427	1	Machine Screw
8040-247	1	Nyloc Hex Nut
0423-377	1	Lock Washer (5 mm)
0541-656	2	Wiper Mount *
1441-712	2	Wiper Mount Seal *
0423-803	2	Machine Screw (6 mm x 16) *
0423-804	2	Flange Nut *
0423-805	2	Rubber Grommet *
0453-480	1	Instructions

*These parts are used to install the wiper mount.

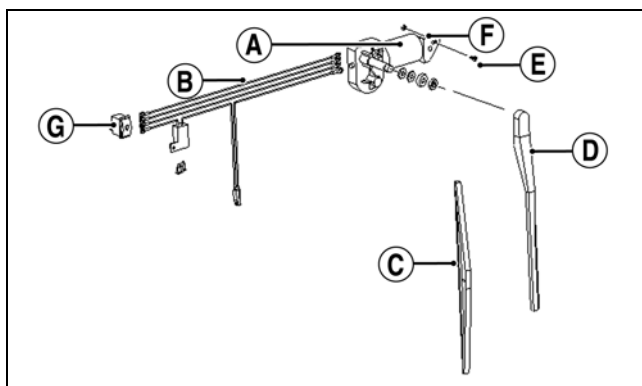

742-517ZA

1. Remove the two 1/4 in. plugs from the top side of the flip-up frame and the one 1/2 in. plug from the front of the flip-up frame.
2. On the left side of the dash, carefully drill a 14.28 mm (9/16 in.) hole with the center of the hole located 1 1/2 in. from the lower windshield panel and 1 1/2 in. to the right of the canopy support tube taking care not to damage the windshield or canopy tube. See Fig. 1.

Fig. 1

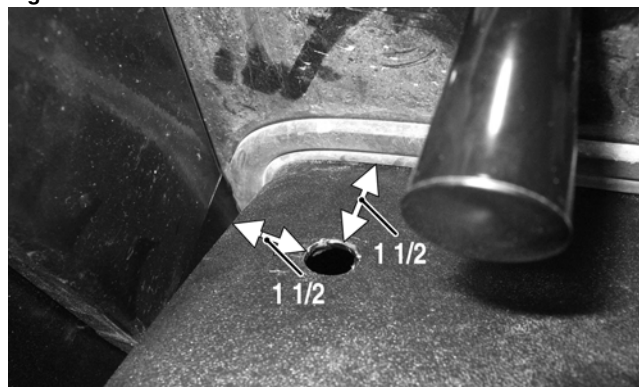

OHUV-055A

3. From beneath the dash, route the three flat terminals and the single-ring terminal on the Harness (B) through the 9/16 in. hole in the dash. See Fig. 2.

Fig. 2



OHUV-052

4. Route the wires through 1/2" hole on front of flip-up frame; then connect the appropriate harness wire terminals to the three flat terminals on the wiper motor. See Fig. 3.

Fig. 3

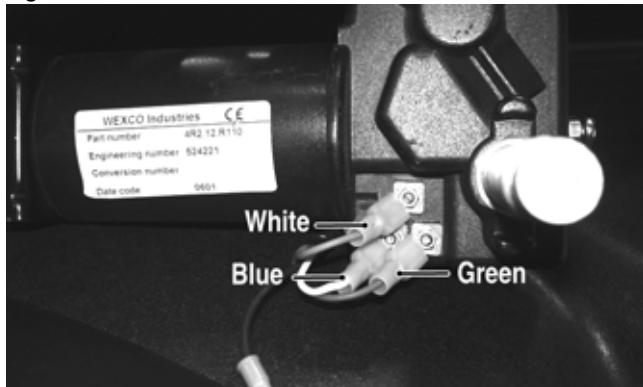

OHUV-029

5. Install the Wiper Blade (C) onto the Wiper Arm (D) by inserting the blade into the bracket at the end of the arm making sure the blade is seated.
6. Insert the small screw (provided with wiper arm) through the wiper arm bracket and blade; then secure with small nyloc nut (provided with wiper arm).
7. Install Wiper Motor (A) to the Wiper Mount and secure with rubber washer, cupped washers, and Large Nut.

■ **NOTE: The rubber washer, cupped washers, and large nut are provided with the wiper motor.**

8. Insert a 1/2 in Machine Screw (E), which is provided with wiper motor, through the wiper mount and wiper motor; then install a Lock Washer followed by the round terminal (black wire) onto the screw. Secure with a Nyloc Hex Nut (F).
9. Install the Seal to the wiper mount (seal prevents the mount from scratching the glass).
10. Secure the wiper mount to the top of the flip-up frame using two 6 mm Machine Screws and Flange Nuts.
11. From under the dash, route the wire harness toward the 2-wire molded plug located next to the key switch beneath the dash; then connect the 2-wire (red and black) molded plug on the wiper harness into the molded plug on the main harness.

■ **NOTE: If the 2-wire molded plug next to the key switch is already being used for another accessory, it will be necessary to use an accessory adapter. Use either the 2-outlet Adapter (p/n 1639-623) or the 3-outlet Adapter (p/n 1639-624).**

12. Cut out the center section of the Template (located on page 3); then cut out the template by cutting along the dotted lines.
13. Position the template on the dash with the left-side dotted line flush with the right edge of the main switch panel on the dash. Trace the outline of the cutout section onto the dash; then remove the template.

14. Using a router bit, cut out the rocker switch mounting hole in the dash; then remove burrs from the edges of the mounting hole. See Fig. 4 for rocker switch mounting location.

Fig. 4



OHUV-028

■ **NOTE: If more than one switch is to be added to the dash, use Switch Panel Kit (p/n 1436-008)**

15. Route the remaining wires from the wiper motor harness through the switch mounting hole in the dash; then connect the white wire to the "Park" terminal on the switch, the red wire to one of the "PWR" terminals, the blue wire to the "Low" terminal, and the green wire to the "High" terminal on the switch. Snap the Rocker Switch (G) into the dash or switch panel. See Fig. 5 for identification of terminals.

Fig. 5

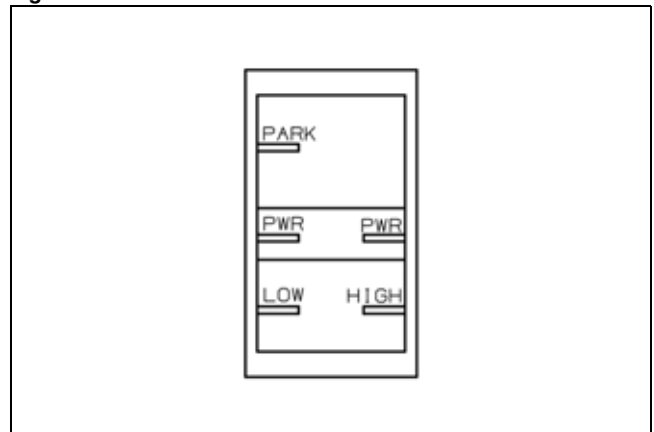

0742-171

16. Secure the wiper motor harness to the canopy tube or windshield frame with Wire-Tie Mounts. See Fig. 6.

Fig. 6

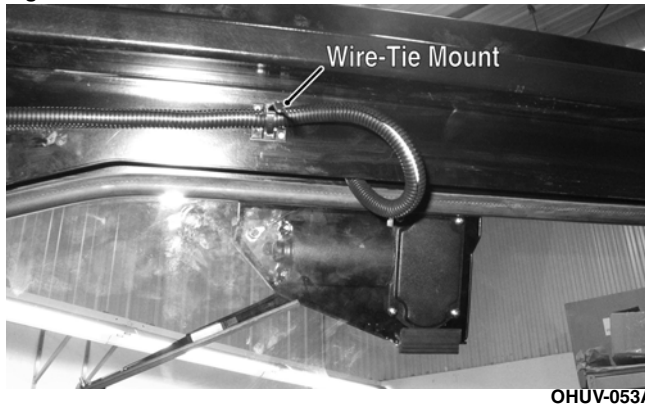

17. With the ignition switch in the OFF position, lightly press the wiper arm and blade assembly onto the wiper motor shaft in the top-center position.

■ **NOTE:** Do not fully seat the wiper arm onto the motor shaft. It may be necessary to remove the arm to adjust the swing of the arm.

■ **NOTE:** The wiper arm will need to be in this position so adjustments can be made to ensure that the wiper blade moves freely and does not come into contact with other components.

18. Adjust the wiper blade making sure it is no closer than 1/2 in. from the windshield edge or other components along the windshield edge when the wiper is in the “Park” position.

■ **NOTE:** If the wiper arm is too long, release the lever on the underside of the arm and shorten the length of the arm. Secure the lever when the desired length is achieved. See Fig. 7.

Fig. 7



■ **NOTE:** If the wiper blade is not centered properly while sweeping, turn off the wiper motor and ignition switch. Pull the wiper arm/blade assembly off the shaft and adjust it until it is centered while sweeping. When the blade has been satisfactorily adjusted, manually press the wiper arm firmly onto the shaft.

CAUTION

Avoid lifting the center of the blade more than 3 in. away from the windshield. Damage to the wiper arm may occur especially in cold weather.

■ **NOTE:** The “Park” position will be on the right side of the windshield (from operator’s viewpoint).

