

Arctic Cat® ATV

Installation Instructions - Accessory Kit

Speedpoint 3-Point Hitch Kit (p/n 1436-078)

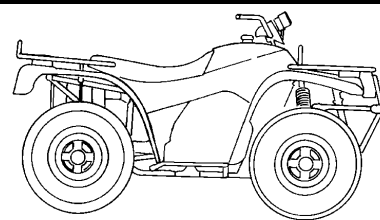

■ **NOTE:** Read these installation instructions thoroughly before beginning the installation process. Retain these Installation Instructions for future reference.

Application:

2006-2008 TRV and 2007-2008 Diesel

2005-2008 FIS (excluding Thundercat, 366, 2005 TRV, and all TBX)

3-Point Hitch Assembly

Ref. No.	QTY	p/n	Description
1	1	1441-503	Warning Decal
2	1	1441-506	Warning Decal
3	1	1441-509	Decal
4	1	1441-483	Actuator
5	4	1441-484	Bushing (Actuator)
6	1	1441-485	Hitch Pin (5/8 in.)
7	1	0541-508	Fixed Hitch
8	1	0541-509	Pivot Hitch
9	1	1441-486	Axle Shaft
10	2	1441-504	Tube Spacer
11	2	1441-488	Pin
12	1	0436-938	Switch and Harness Sub-Assembly
13	2	0541-668	Hitch Link
14	1	0541-670	Mounting Bracket (Right Side)
15	1	0541-671	Mounting Bracket (Left Side)
16	1	0541-742	Link Rod
17	1	0541-743	Pin (Lower Mount)
18	2	0541-512	Pneumatic Hub/Wheel Assembly
19	2	1441-489	Collar (3/4 in.)
20	4	0423-823	Clevis Pin
21	3	0423-690	Flange Lock Nut (1/2 in.)
22	2	0423-691	Flat Fender Washer (5/16 x 1 1/4 x 1/8 in.)
23	2	0423-692	Hex-Head Bolt (5/16-18 x 3/4 in.)
24	1	0423-693	Hex-Head Bolt (1/2-13 x 3 1/4 in.)
25	1	0423-694	Hex-Head Bolt (1/2-13 x 4 in.)
26	1	0423-695	Hex-Head Bolt (1/2-13 x 4 1/2 in.)
27	8	0423-696	Hitch Pin Clip
28	2	0423-697	Lock Washer (5/16 in.)

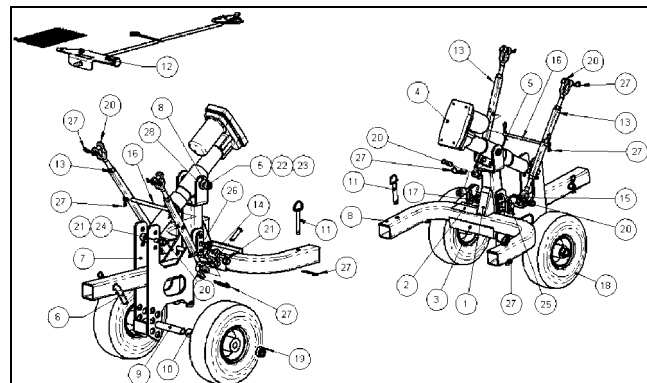

ATV-175

Switch Assembly (Not Illustrated)

Ref No.	p/n	QTY	Description
1	0409-084	1	Seal (Toggle Switch)
2	0409-085	1	Toggle Switch
3	0409-086	1	Wiring Harness
4	0541-528	1	Switch Bracket
5	1411-524	1	Decal (Up/Down)
6	8408-816	2	Cap Screw (8 mm x 1 1/4 - 16)
7	8424-802	2	Flange Hex Nut (8 mm x 1 1/4)
8	0423-594	2	Clamp
9	0123-788	10	Cable Tie

Setup - 3-Point Hitch

1. Remove the components from the shipping package; then verify that there are no missing or damaged components. See Bill of Materials (BOM) for list of parts included in kit.
2. Place the ATV on a flat surface and secure with the parking brake.
3. Position Fixed Hitch (7) onto the ATV receiver hitch and secure with Hitch Pin (6) and Clip. See Fig. 1.

Fig. 1

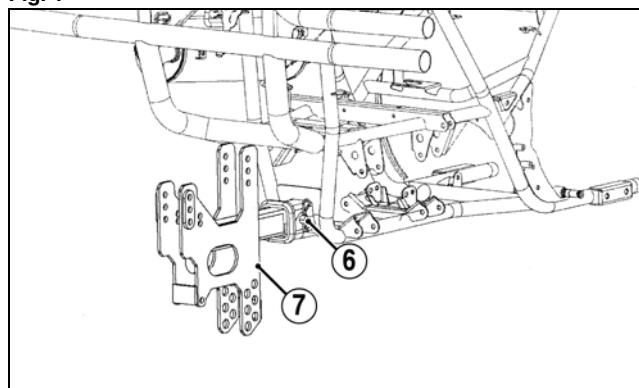

ATV-1123

4. Position Pivot Hitch (8) onto the fixed hitch and secure with 1/2-13 x 4 1/2 in. Hex-Head Bolt (26) and Flange Lock Nut (21). Tighten securely. See Fig. 2.

Fig. 2

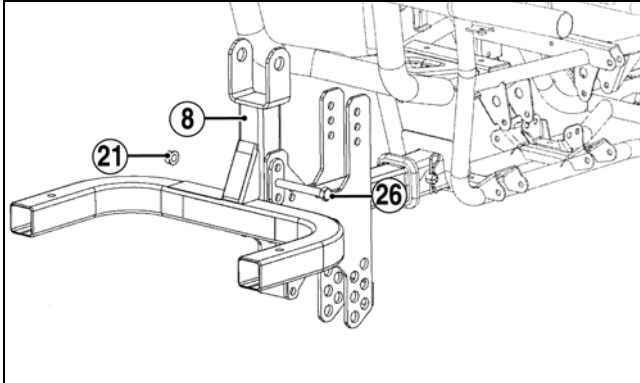

ATV-1122

5. Install Pneumatic Hub/Wheel Assembly (18) using Axle Shaft (9), Tube Spacers (10), and Collars (19). Tighten both collars securely at this time. See Fig. 3.

Fig. 3

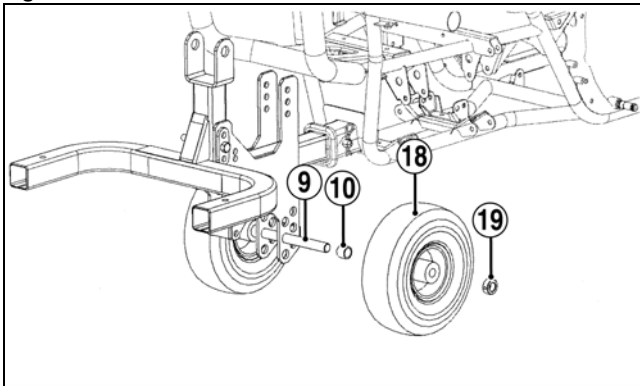

ATV-1121

6. Grease both wheels; then clean off excess grease from the wheel assembly.

■ **NOTE:** With no one sitting on the ATV, the 3-point hitch wheels should be approximately 3-4 inches off the ground while no implement is attached.

7. Position the Actuator (4) onto the pivot hitch; then secure with Bushing (5), Flat Washer (22), Lock Washer (28), and 5/16-18 x 3/4 in. Hex-Head Bolt (23). Do not tighten at this time. See Fig. 4.

Fig. 4

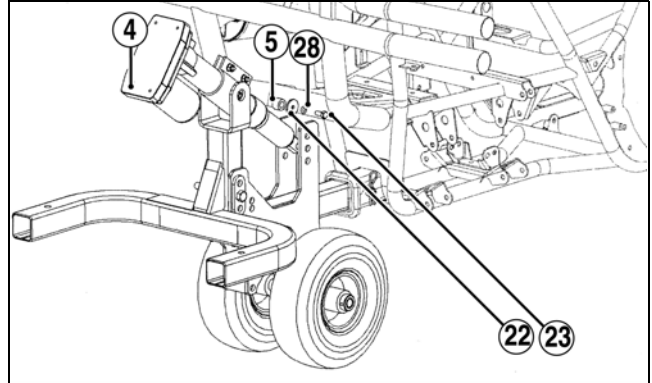

ATV-1125

8. Repeat for opposite side. Tighten securely.
9. Making sure a Bushing (5) is placed on either side of the actuator, secure the front of the actuator to the fixed hitch with 1/2-13 x 3 1/4 in. Hex-Head Bolt (24), and Flange Lock Nut (21). See Fig. 5.

Fig. 5

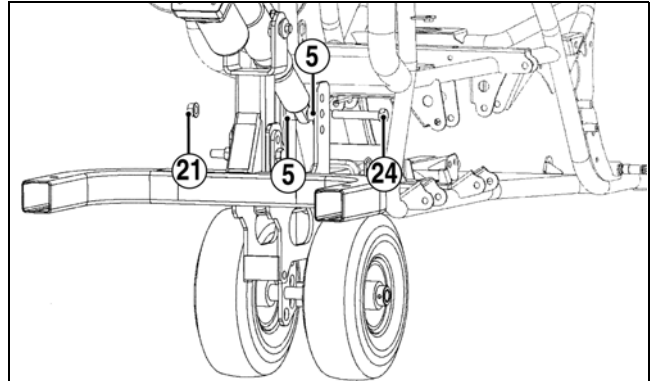

ATV-1124

■ **NOTE:** It may be necessary to loosen the sleeve that holds the actuator to the hitch and then slide the actuator so that the rubber boot on the front of the actuator is touching the sleeve; then securely tighten the sleeve. If the sleeve slips while lifting an attachment, tighten the sleeve more.

10. To install lower Mounting Brackets (14 & 15), first insert the Pin (17) into the lower hole. See Fig. 6
11. Install the right-side and left-side Mounting Brackets (15) over the pin. Install the Hex Head Bolt (25) into the corresponding hole. Secure with Flange Lock Nut (21). See Fig. 6.

12. Tighten all fasteners securely.

Fig. 6

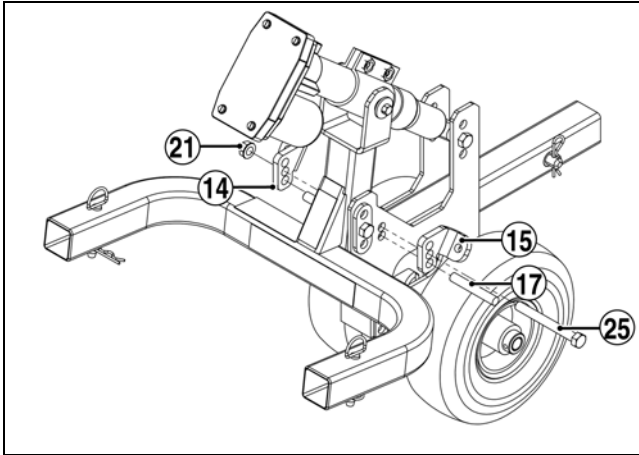

13. To install Hitch Links (13), place one end of each link onto the upper mount; then secure with Clevis Pins and Hitch Pin Clips. See Fig. 7.

14. With the upper end of each hitch link fastened to the appropriate upper mounts (purchased separately), rotate each link to allow the lower clevis pin to be installed through the link clevis and lower mounting brackets. See Fig. 7.

Fig. 7

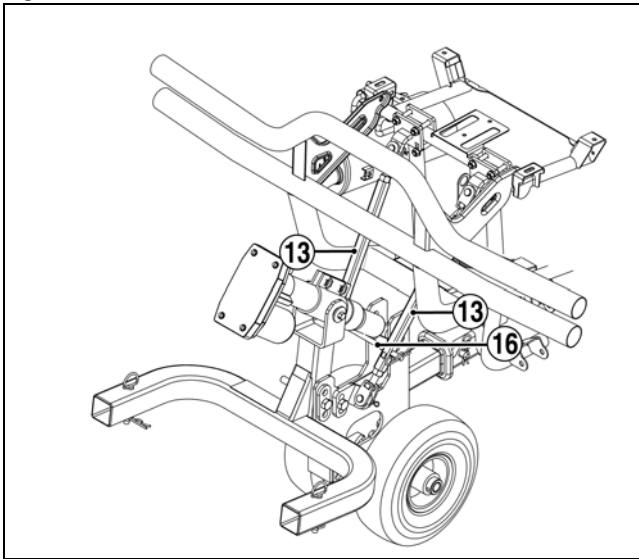

15. Once both links are installed, turn each link to shorten its length until all slack is removed from each link.

16. Slide the Link Rod (16) through the openings in the body of each hitch link to prevent the hitch links from turning; then secure with hitch pin clips. See Fig. 7.

Wiring Instructions (All models except TBX)

1. Remove the two screws securing the battery cover. Disconnect the battery cables making sure to disconnect the negative cable first.

2. Route Wiring Harness from the battery under the right side of the body panel following the main ATV wiring harness toward the rear of the ATV. See Fig. 8 and 9.

Fig. 8



Fig. 9

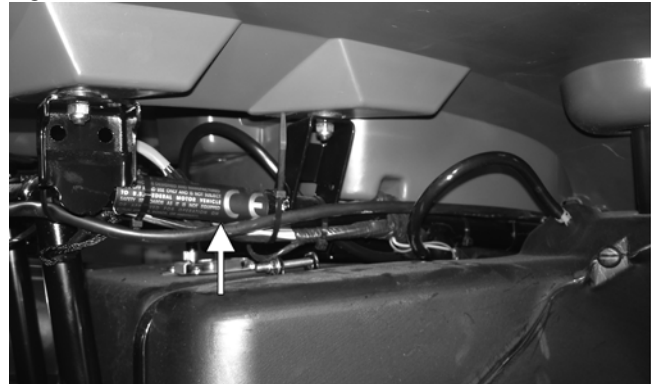

3. Next to the right side of the taillight, route the harness up and along the bottom side of the rear rack toward the left side of the ATV. Follow the rack to the front left corner. See Fig. 10.

Fig. 10



4. With the switch installed in Mounting Bracket, plug the red wire and black wire connectors to either of the two center terminals on the switch. Plug the red/white wire and black/white wire into the remaining two terminals. See Fig. 11. Secure harness with cable ties as needed.

Fig. 11

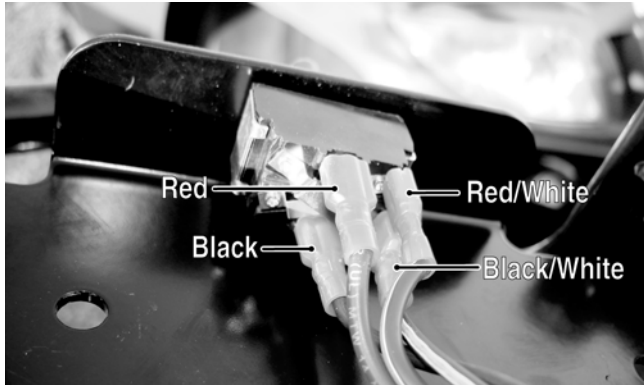

ATV-138A

5. Mount the bracket on the rack using two Screws, Nuts, and P-Clamps provided.

■ **NOTE:** When mounting the bracket to the rack, use the two center holes in the bracket. Tighten securely. See Fig. 12.

Fig. 12



ATV-068

6. Connect the red and black power wires along with the positive and negative cables to the battery. Reinstall all remaining parts.

■ **NOTE:** After the harness has been connected to the 3-point hitch system, make sure the switch works in conjunction with the up/down decal. If it doesn't, simply loosen the switch and rotate it 180 degrees and secure.

7. The 3-point hitch has several possible adjustments available. The factory settings are the recommended positions of these adjustments. However, if an implement attached to the hitch is not performing to the desired level, this can be adjusted. Please refer to the setup and troubleshooting sections for each specific implement on instructions for adjustments.
8. The 3-point hitch is now installed and ready to be attached to an implement designed to fit the hitch. It is possible to maneuver the ATV with the installed hitch into position to attach an implement.
9. Cycle the 3-point hitch up and down approximately 25 times before its initial use. This "break in" will help prevent mechanical failures ("break in" should be done with the engine running and no attachments installed).

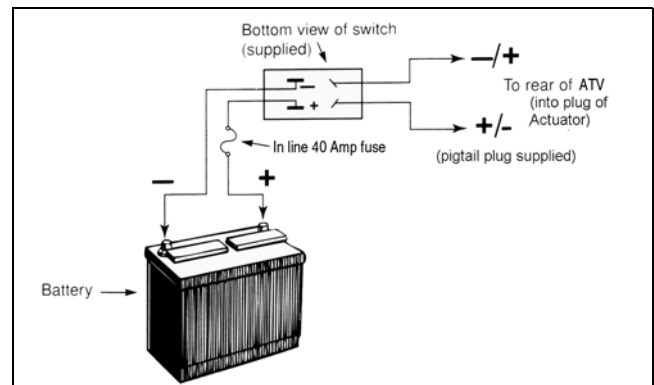

ATV-077A

