

Arctic Cat® ATV

Installation Instructions - Accessory Kit

Speedpoint Upper Link Mounting Kit (p/n 1436-115)

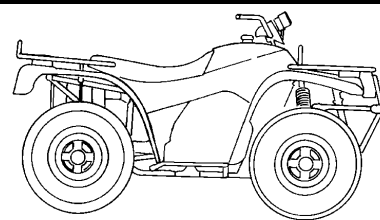

■ **NOTE:** Read these installation instructions thoroughly before beginning the installation process. Retain these Installation Instructions for future reference.

Application:

2005-2008 FIS Models (excluding the Thundercat, 366, 2005 TRV, and all TBX models)

Kit includes:

p/n	QTY	DESCRIPTION
1441-668	2	Mounting Plate (Front)
1441-670	2	Mounting Plate (Rear)
0423-824	8	Carriage Bolt (5/16 x 2.0 in.)
0423-814	8	Flange Lock Nut (5/16 in.)
0453-507	1	Instructions

1. Center Mounting Plate (1) on the rear face of the junction tube with the lug angling downward and to the rear; then center Mounting Plate (2) on the opposite face of the junction tube. See Fig. 1.

2. Secure the mounting plates using four Carriage Bolts (3) and Flange Lock Nuts (4) making sure the carriage bolts are inserted from the front of the vehicle.
3. Tighten evenly and securely.
4. Repeat for opposite side.

Fig.1

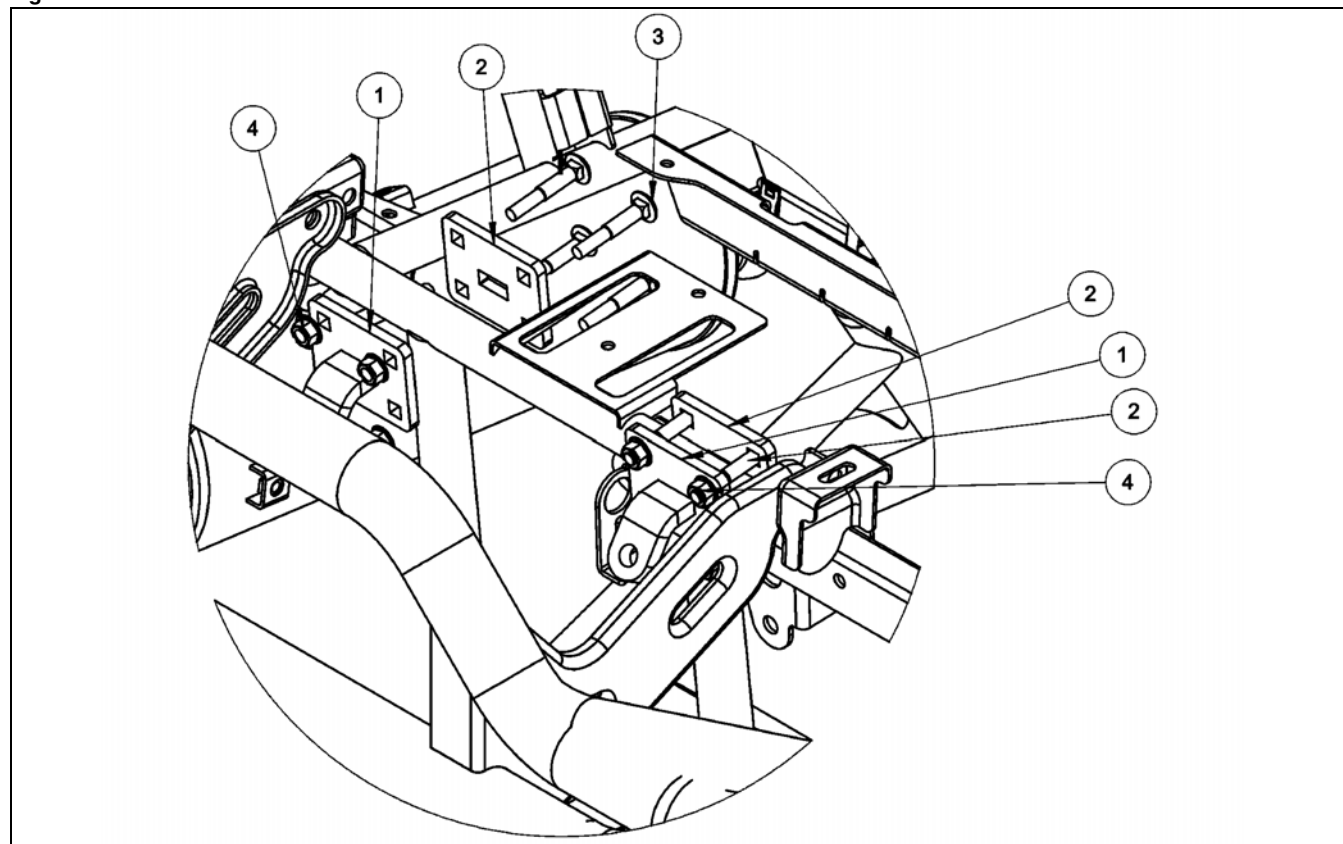

ATV-1117

