

Arctic Cat® UTV

Installation Instructions - Accessory Kit

Windshield Kits (p/n 1436-277/278)

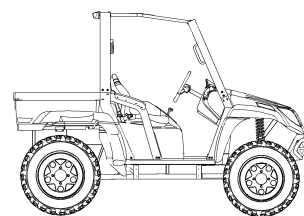

■ **NOTE:** Read these Installation instructions thoroughly before beginning the installation process. Retain these Installation Instructions for future reference.

Application: All Prowler Models

Kit includes:

p/n	QTY	DESCRIPTION
0541-599	1	Slider Vent
1441-635	1	Glass Windshield
1441-636	1	Weatherstrip
0423-773	1	Tapered Handle
0423-772	9	Flat Washer
0423-774	2	Nyloc Nut (1/4-20)
1441-402	1	Dash Seal
1441-647	1	Shim
0541-600	1	Flip-Up Frame*
1441-638	1	Rubber Seal*
1436-038	1	Hardware Kit *
0423-799	1	Windshield Latch*
0453-586	1	Instructions

*Included in Kit (p/n 1436-278)

■ **NOTE:** If the vehicle is equipped with a roof, remove the roof and header before beginning these instructions.

1. Remove the cap screw and nut from the dash mounting bracket. Account for two shims which will be used following step 4 (if applicable).
2. Using a T-40 wrench, remove the four torx-head screws (two per side) located on the outside of the canopy frame tube next to the bottom of the windshield. See Fig. 1.

Fig. 1



UTV-051A

3. Remove the four cap screws securing the top front of the canopy to the right-side and left-side cross-braces. See Fig. 2.

Fig. 2



OHUV-050

4. Place the Windshield Panel Assembly (A) or (B) onto the front canopy tube making sure they overlap the two panel posts and that the mounting holes align. Using a T-40 wrench and the four screws removed in step 2, secure the lower front panel assembly. Tighten to 20 ft-lb. See following NOTE for instructions if doors are not installed. See Fig. 3 and Fig. 4.

Fig. 3

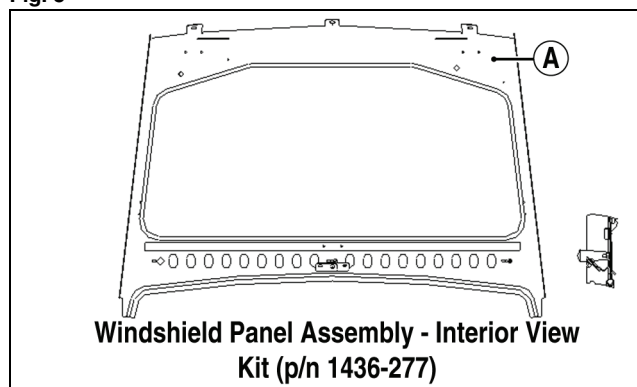

742-503B

Fig. 4

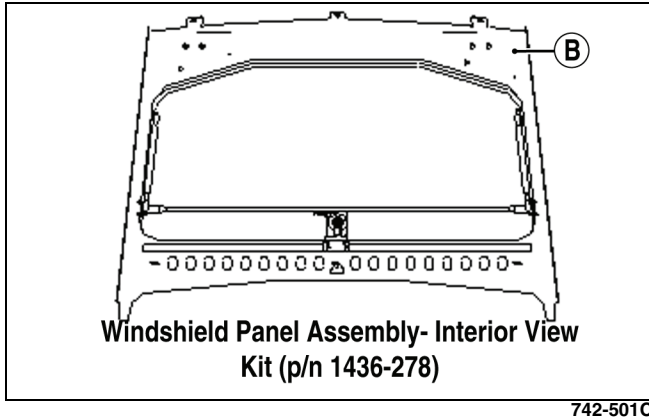

■ **NOTE:** If a door kit is not being installed, place a shim (removed in step 1) between the lower canopy and the front panel mounting locations. See Fig 1.

5. Secure the two inside brackets on windshield panel assembly (A) or (B) to the top of the canopy cross-brace using hardware removed in step 3. See Fig. 2. Tighten to 20 ft-lb.

6. Secure the upper outer section of the Windshield Panel to the right-side and left-side of the header using four 6 mm x 1.0 Machine Screws and U-Clips (provided in Roof Kit p/n 1436-012).
7. Securely tighten all hardware.
8. If necessary, bend the dash mounting bracket downward until it conforms to the contour of the dash; then using the dash bracket as a template, carefully drill a 15/64 in. hole through the dash. Secure the dash bracket to the dash using the cap screw and nut removed in step 1.
9. If installing Windshield Kit (p/n 1436-278) (B), install the windshield latch as follows. From inside the windshield frame and using the provided hardware, install the Windshield Latch; then install the latch striker onto the striker mounting bracket (if applicable).



Arctic Cat® OHUV

Installation Instructions - Accessory Kit

Rear Panel Kit (p/n 1436-039) & (p/n 1436-041)

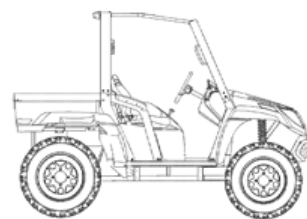

■ **NOTE:** Read these installation instructions thoroughly before beginning the installation process. Retain these Installation Instructions for future reference.

Application

All Prowler models

Kit includes:

p/n	QTY	DESCRIPTION
0541-606	1	Rear Panel Assembly *
0541-605	1	Rear Slider Panel Assembly **
1436-040	1	Hardware Kit
N/A	4	Rear Panel Spacer (1.0 in.)
N/A	4	Machine Screw (6 mm x 1.0 x 45)
N/A	2	Clamp (1.125)
N/A	2	Clamp (.750)
N/A	2	Machine Screw (6 mm x 1.0 x 20)
N/A	4	Flange Nyloc Nut
N/A	4	Flat Washer
0453-465	1	Instructions

*Included in Kit (p/n 1436-039)

** Included in Kit (p/n 1436-041)

■ **NOTE:** The hardware components in Hardware Kit (p/n 1436-040) cannot be ordered separately. Hardware Kit (p/n 1436-040) must be ordered.

1. Install the Rear Seal (A) around the Rear Panel Assembly making sure the seal is firmly seated around the entire perimeter. See Fig.1 or Fig. 2.

Fig. 1

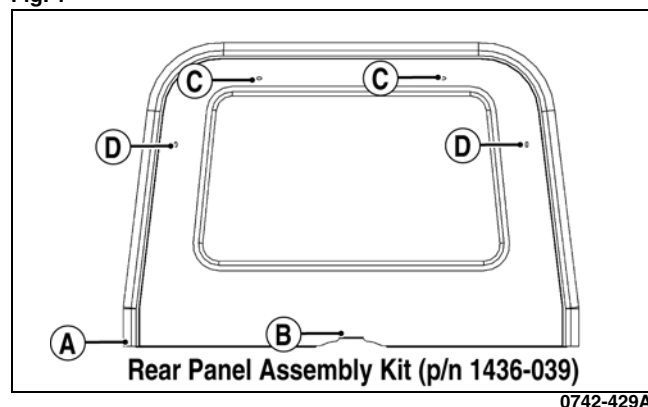
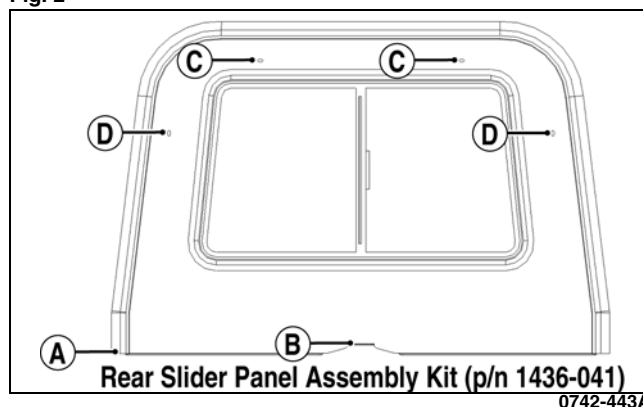

Fig. 2



2. Remove the two torx-head screws (B) located between the lower ends of the V-Brace tubes.
3. From the rear of the vehicle, properly position the rear panel assembly w/seal onto the vehicle; then align the bottom mounting holes with the two holes from which the screws were removed in step 2. Secure the panel assembly with the screws removed in step 2. Tighten to 1.1 kg/m (8 ft-lb).
4. Place the two larger Clamps (C) onto the V-brace tubes with the flat side of the clamps positioned against the inside face of the rear panel. Align the clamp mounting holes with the rear panel mounting holes and Rear Panel Spacer; then from the backside of the panel, insert two 6 mm Machine Screws w/Flat Washers. Secure the clamps with Flange Nyloc Nuts.
5. Place the smaller Clamps (D) onto the horizontal headrest support tubes with the flat side of the clamps positioned against the inside face of the panel. Align the clamp mounting holes with the panel mounting holes and the spacer; then from the backside of the panel, insert the remaining two 6 mm Machine Screws w/ Flat Washers. Secure with Nyloc Nuts.



Arctic Cat® Prowler

Installation Instructions - Accessory Parts

Roof Kit (p/n 1436-330)

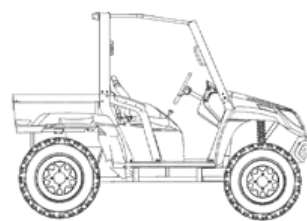

■ **NOTE:** Read these installation instructions thoroughly before beginning the installation process. Retain these Installation Instructions for future reference.

Application: All Prowler Models

Kit includes:

p/n	QTY	DESCRIPTION
1441-601	1	Roof (Plastic)
1441-876	1	Header Panel (Right Side)
1441-877	1	Header Panel (Left Side)
1441-646	1	Seal (Roof)
N/A	1	Windshield/Roof Support *
1436-046	1	Hardware Kit (Roof)
N/A	4	Insert
N/A	5	Machine Screw (8 mm)
N/A	8	Machine Screw (6 mm)
N/A	10	Fender Washer (Rubber)
N/A	5	Flat Washer
N/A	5	U-Nut Clip (8 mm)
N/A	4	U-Nut Clip (6 mm)
0453-593	1	Instructions

* Not included in kit. For illustration purposes only.

■ **NOTE:** The hardware components in Hardware Kit (p/n 1436-046) cannot be ordered separately. If replacement components are required, order hardware kit.

■ **NOTE:** If also installing a windshield, the windshield must be installed first (proceed to step 2).

1. Install Windshield/Roof Support. See instructions in Windshield/Roof Support Kit (p/n 1436-047).
2. Press the four Inserts into the pre-cut hexagonal-shaped holes on the rear face of the rear canopy tube.
3. Position Left-Side Header Panel (A) into place with the front of the windshield or windshield roof support positioned on the inside of the windshield or windshield/roof support. Align the rear mounting holes with the inserts; then thread the 6 mm Machine Screws (B) into the inserts. See Fig. 1.

Fig. 1

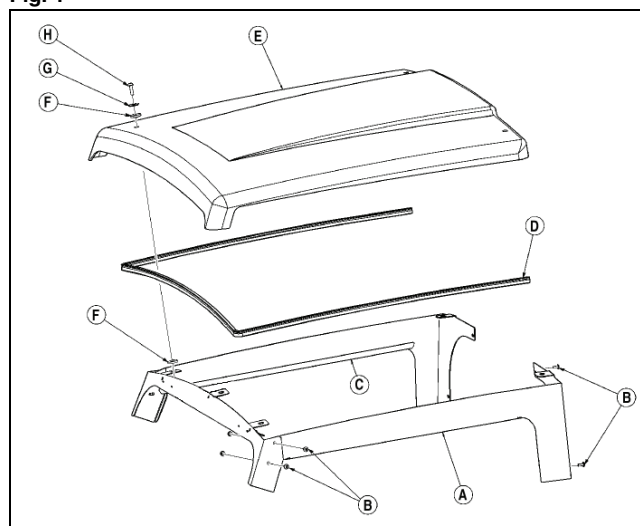

436-841A

4. While applying pressure to the rear of the panel, tighten the machine screws.

■ **NOTE:** The inserts will self-tighten inside the rear canopy tube as the screws are tightened.

5. Secure the front of the roof panel to the windshield or windshield/roof support using two 6 mm machine screws and 6 mm U-Nut Clips.
6. Repeat steps 3-5 for Right-Side Header Panel (C).
7. Install Rubber Seal onto left-, right- and front side panels. Note where rubber seal contacts the three front roof mounting tabs.
8. On the front panel, cut on the inside of the rubber seal to allow it to be placed on front panel as one piece.

■ **NOTE:** It is best to cut one tab at a time to allow for a continuous seal for the roof. It may also be necessary to snip out a "V" notch on the inside corners where the side panel and front panel connect.

9. Press rubber seal into place making sure it is fully seated.
10. Install the five 8 mm U-Nut Clips onto the five tabs supporting the roof.

11. Position Plastic Roof (E) onto the top of the canopy.
12. Raise the corner of the roof slightly; then place a Rubber Fender Washer (F) on the underside of the panel mounting hole with the raised side facing upward. Place another fender washer (F) on top of the roof at the same mounting location with the raised side of the washer facing downward. Place a Flat Washer (G) on top of the fender washer (located on top of the roof).
13. From the top of the roof, insert an 8 mm Machine Screw (H) through the hardware (installed in step 11) and through the windshield or header panel; then secure with 8 mm U-nut clips. Loosely tighten machine screw.
14. Repeat steps 10-12 for the remaining four roof mounting locations.
15. Carefully tighten the machine screw until the top rubber washers are slightly compressed.

**CAUTION**

Do not over-tighten. Damage to the roof may occur.



Arctic Cat® UTV

Installation Instructions - Accessory Kit

Door Kits (p/n 1436-279 and 1436-280)



■ **NOTE:** Read these installation instructions thoroughly before beginning the installation process. Retain these Installation Instructions for future reference.

Application: All Prowler Models

Included in Kit (p/n 1436-279):

p/n	QTY	DESCRIPTION
0541-764	1	Solid Glass Door Kit (Right Side)
0541-786	1	Hinge Plate *
0541-790	1	Door Assembly w/Solid Glass (Right Side)*
1436-146	1	Hardware Kit *
0541-765	1	Solid Glass Door Kit (Left Side)
0541-787	1	Hinge Plate **
0541-791	1	Door Assembly w/Solid Glass (Left Side)**
1436-146	1	Hardware Kit **
0453-588	1	Instructions

* Included in Kit (p/n 0541-764)

** Included in Kit (p/n 0541-765)

Included in Kit (p/n 1436-280)

0541-762	1	Sliding Glass Door Kit (Right Side)
0541-786	1	Hinge Plate *
0541-788	1	Door Assembly w/Slider Window (Right Side)*
1436-146	1	Hardware Kit *
0541-763	1	Sliding Glass Door Kit (Left Side)
0541-789	1	Door Assembly w/Slider (Left Side)**
1436-146	1	Hardware Kit **
0541-787	1	Hinge Plate**
0453-588	1	Instructions

* Included in Kit (p/n 0541-762)

** Included in Kit (p/n 0541-763)

- Using a T-40 wrench, remove the two upper and two lower torx-head screws from the right-side and left-side front canopy frame tubes.

■ **NOTE:** The upper screws are located on the outside of the canopy frame tube next to the bottom of the windshield and the lower screws are located on the outside of the canopy frame tube near the floor board.

- Position left-side Hinge Plate flush against the front canopy frame tubes and secure with screws removed in step 1. Tighten only the top screw at this time. Do not tighten the remaining screws at this time since the door may need to be adjusted later.

- Repeat step 2 for opposite side.

■ **NOTE:** If a windshield is also being installed, refer to Windshield Kit (p/n 1436-277/278) and complete the installation of the windshield before continuing with the installation of the doors.

- Install the striker bolt onto the striker mounting plate using washers and hex nut. Do not tighten at this time.

■ **NOTE:** The striker bolt should be installed outside the center bend under the arm rest.

- Install two inserts into the pre-cut hexagonal shaped holes located on the downward angled rectangular tube under the arm rest.

■ **NOTE:** The inserts will self-tighten inside the rectangular tube as the screws are tightened.

- Position the striker mounting plate with the striker bolt facing forward and the front face of the plate in a vertical position.
- Position the striker plate against the two inserts; then secure the striker plate using two flange screws. Tighten securely.
- Place a brass washer onto each of the two door hinges; then install the left-side door.

■ **NOTE:** To aid in the installation of the door, it may be necessary to open and close the door as the door is pushed downward onto the hinges.

- Adjust the hinge plate until the bottom edge of the door is level with the lower frame tube. Tighten the upper and lower torx-head screws on the hinge plate to 20 ft-lb.
- Repeat steps 3-8 for right-side door.
- With both doors installed, adjust the striker bolt until the doors latch properly. Securely tighten the striker bolts.

■ **NOTE:** If door assemblies still do not latch. The hinge plate may need to be re-adjusted. See Fig. 2.

Fig. 2.

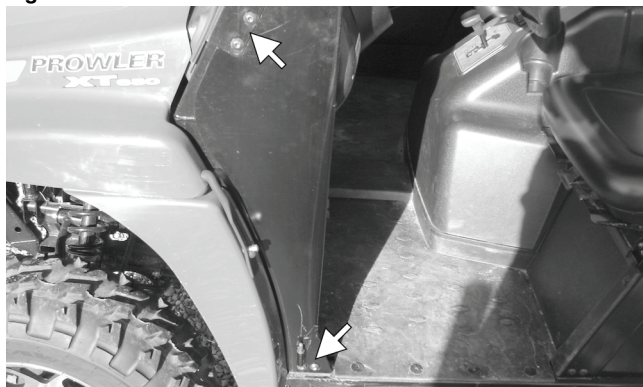

UTV-052A

12. Install Clip (B) inside Hinge Plate (A). Secure with Torx-Head Screw (C) and hex nut. See Fig. 3.

■ NOTE: Clip will secure hinge plate to canopy tube.

Fig. 3

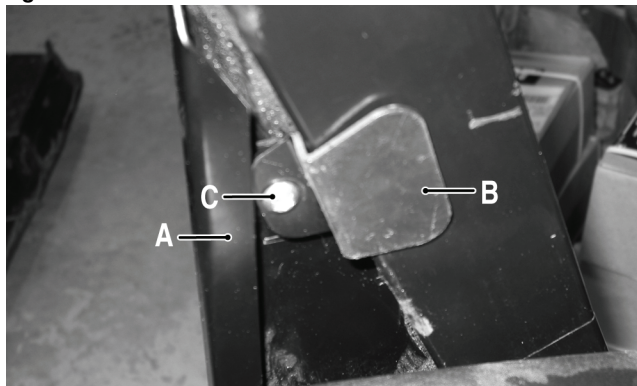

OHUV-073

