

Arctic Cat® ATV

Installation Instructions - Accessory Kit

Molded Rack Tray Kit (p/n 1436-381/906)

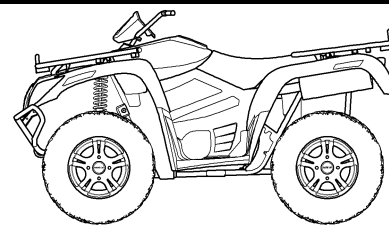

■ **NOTE:** Read these installation instructions thoroughly before beginning the installation process. Retain these Installation Instructions for future reference.

Kit includes:

p/n	QTY	DESCRIPTION
0541-959	1	Molded Tray
8476-630	4	Machine Screws
0623-184	4	Flat Washer
1441-993	4	Insert
N/A	1	Divider Template
0453-690	1	Instructions

1. Remove the existing four Speedrack inserts from the front rack; then install four new Inserts (by pressing in the four tabs) into the front rack from the bottom side until they snap completely into place. See Fig. 1.

Fig. 1



ATV-2076

■ **NOTE:** When installing inserts, be sure to install the flat bottom side of the insert along the rack tube or brackets.

2. With Molded Tray aligned with the four inserts, secure the molded tray to the rack using Four Machine Screws, and four Flat Washers. Tighten securely. See Fig. 2.

Fig. 2

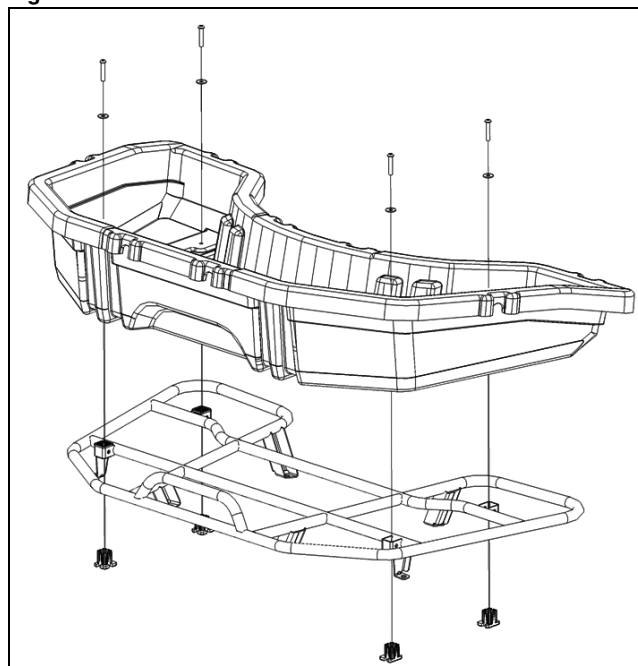

ATV-3020

Optional

3. Use provided Divider Template to cut 3/4-in. wooden dividers.
4. Add notches, slots, holes, or whatever customization you chose to help hold your items in place.



DIVIDER TEMPLATE

The line below should be
2 inches long if this
print is printed to scale.
(Use a ruler to verify)



(DO NOT DISCARD AND SAVE FOR FUTURE USE)

USE THIS TEMPLATE AS A GUIDE TO CUT OUT 3/4" THICK WOODEN DIVIDERS
FOR YOUR MOLDED RACK TRAY.

NOTE: YOU CAN CUSTOMIZE YOUR DIVIDERS BY CUTTING SLOTS OR HOLES
TO HELP HOLD THINGS LIKE CHAINSAWS AND HAND TOOLS.

