

Arctic Cat® Wildcat

Installation Instructions - Accessory Kit

Front Winch Mount Kit

(p/n 1436-692)

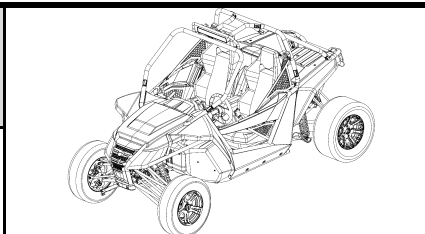

■ **NOTE:** Read these Installation Instructions thoroughly before beginning the installation process. Retain these Installation Instructions for future reference.

Application: Wildcat

Kit includes:

Ref. No.	p/n	QTY	DESCRIPTION
1	*	2	Button-Head Screw (M6)
2.	*	2	Cap Screw (M10)
3	*	2	Lock Nut (M10)
4	2441-187	1	Mount
5	2441-186	1	Mount Bracket
N/A	0453-853	1	Instruction

* Included in Hardware Kit (p/n 0541-075)

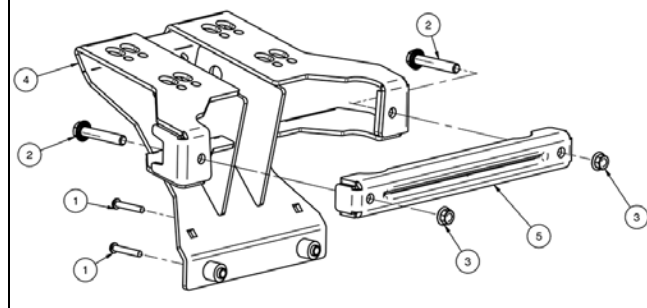

WARNING

Several actions performed by the user could be hazardous if common sense is not followed. Always use common sense when using this product. Never carry passengers on mount.

1. Remove the bottom two torx-head screws securing the front fascia to the frame.
2. Loosely secure the bottom of Mount using two M6 Button-Head Screws into the holes from step 1. See Fig. 1.

Fig. 1

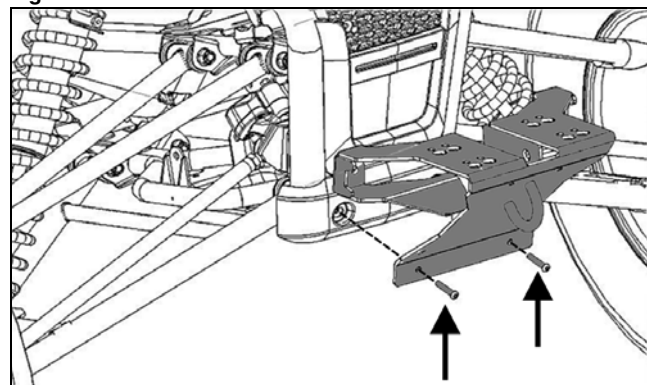

ROV-190A

3. Position Mount Bracket behind front frame tubes making sure that the half circle pipe grooves are facing up. See Fig. 2.

Fig. 2

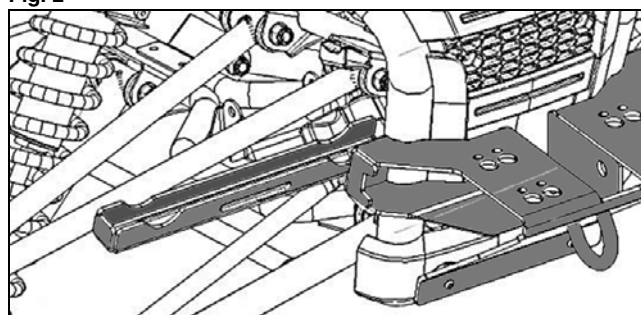

ROV-191

4. Once the bracket is positioned, rotate it so the half circle pipe grooves are placed around the frame tubes. See Fig. 3.

Fig. 3

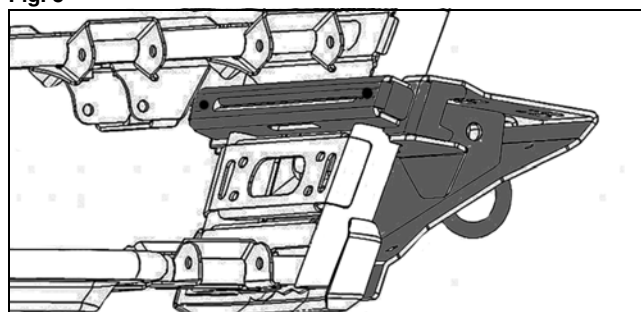

ROV-200

5. Secure the mount to the mounting bracket using two M10 Cap Screws and two Lock Nuts. Tighten to 35 ft-lb alternating from side-to-side to ensure even pressure is applied. Tighten the bottom screws to 7.5 ft-lb. See Fig. 4.

Fig. 4

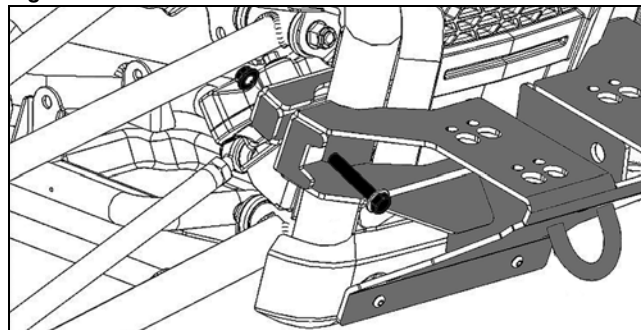

ROV-200

6. Using the four cap screws provided with the winch kit, secure the winch to the mount making sure to use the exterior holes for a 4000 lb winch and the interior holes for a 3000 lb winch.

■ **NOTE:** The winch carrier can also be secured to the mount using the carrier pin and clevis pin.