

Arctic Cat® Wildcat 4

Installation Instructions - Accessory Kit

Soft Doors Kit (p/n 1436-675)

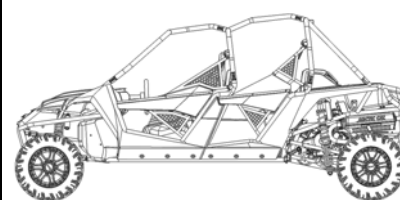

■ **NOTE:** Read these Installation Instructions thoroughly before beginning the installation process. Retain these Installation Instructions for future reference.

Application: Wildcat 4

Kit includes:

p/n	QTY	DESCRIPTION
0541-047	1	Front Door Aluminum Bracket Kit (LH & RH) (A)
2441-192	1	Operator Side Front Door
2441-193	1	Passenger Side Front Door
2441-194	1	Operator Side Rear Door
2441-195	1	Passenger Side Rear Door
*	8	Wing Nut
*	4	M6 Screws
*	4	Front Mounting Bracket (LH & RH)
*	2	Spacer
*	2	Screw (M5 x 35 mm)
*	4	Clamp Screw
0541-862	1	Rear Door Aluminum Bracket Kit (LH & RH) (B)
0541-892	1	Seal Kit
0123-903	2	Cable Tie
0541-894	4	Windshield Clamps
0541-895	2	Front Door Velcro Straps
0453-884	1	Instructions

* Included in Hardware Kit (p/n 0541-893)

■ **NOTE:** For determining the top and bottom of the brackets, the side with the longer space between bends is the bottom of the bracket. Take note of the hole locations in the middle of the bracket for front or rear brackets. See Fig. 2.

Fig. 2

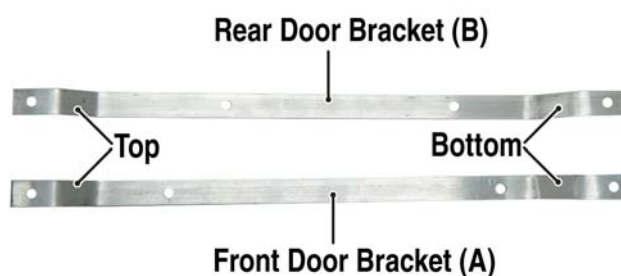

ROV-260A

Installing Front Doors

1. Unlatch the front left door; then using a flat head screw driver, remove the plastic plug from the end of each door (near the latch). See Fig. 1.

Fig. 1



ROV-256A

2. Remove the torx-head screws from the safety net and install Aluminum Door Bracket and re-install the net using the existing screws and washers. Do not over-tighten. See Fig. 3 and 4.

Fig. 3



ROV-257A

Fig. 4



ROV-258A

■ **NOTE:** For ease of the installation process, unzip the window.

3. Install Front Left-Side Door into the end of the wildcat door (where the plug was removed). See Fig. 5.

Fig. 5



ROV-261

4. Install the rear of the door into the top of the bracket first; then install into the lower mounting location and secure using both wing nuts. See Fig. 6.

Fig. 6



ROV-262A

5. Install front Velcro Strap around the bottom frame tube and up to and around the rear passenger hand hold. Secure with the velcro and the middle with a Cable Tie (A). See Fig. 7.

Fig. 7



ROV-268A

■ **NOTE:** If the doors are to be removed, remove the bottom wing nut first then the top.

6. Secure the rear of the door to the velcro strap (from step 5).

■ **NOTE:** If Flip-Up Windshield Kit (p/n 1436-739) is installed, remove the four screws and clamps and replace with the supplied clamps and screws from this kit. See Fig. 8.

Fig. 8

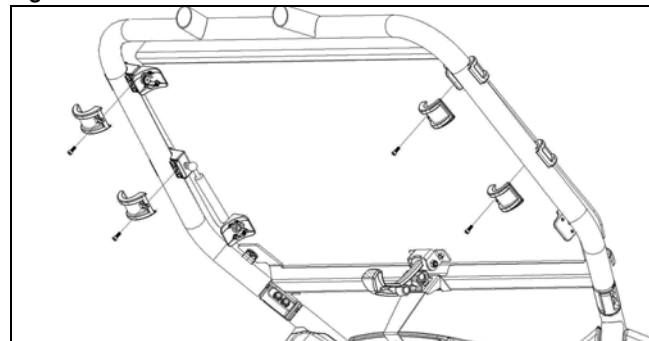

ROV-078

Installing Rear Doors

1. Unlatch the rear left door; then using a flat head screw driver, remove the plastic plug from the end of each door (near the latch). See Fig. 9.

Fig. 9



ROV-263A

2. Remove the torx-head screws from the safety net. See Fig. 10.

Fig. 10



3. Position Rear Aluminum Door Bracket; then secure the top of the safety net and bracket using the supplied Screw (M5 x 35 mm), M6 Washer, net tab, aluminum bracket and Spacer (in that order). Do not over-tighten. See Fig. 11.
4. Secure the bottom of the safety net and bracket using existing screw, net tab, washer, aluminum bracket (in that order). Do not over-tighten. See Fig. 11.

Fig. 11



■ **NOTE:** For ease of the installation process, unzip the window.

5. Install Rear Left-Side Door into the end of the wildcat door (where the plug was removed). See Fig. 12.
6. Install the rear of the door into the top of the bracket first; then install into the lower mounting location and secure using both wing nuts. See Fig. 12.

Fig. 12

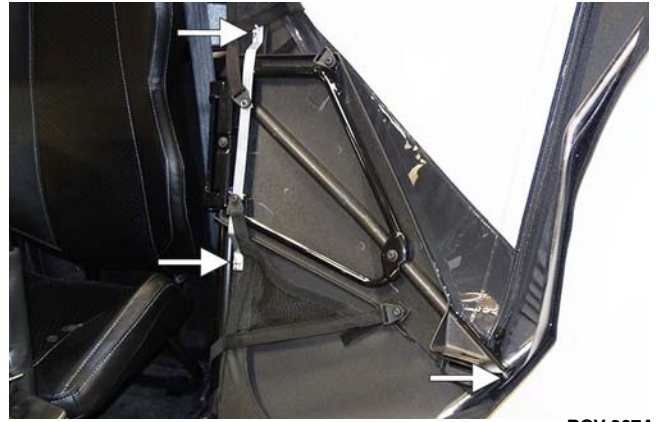

■ **NOTE:** If the doors are to be removed, remove the bottom wing nut first then the top.

7. Secure the rear of the door to the velcro strap of the roof/back panel. See Fig. 13.

Fig. 13



Installing Seal Kit (p/n 0541-892)

1. Inner Panel Close Off
2. Steering Post Close Off
3. Lift Support Close Off
4. Passenger Fender Close Off
5. Operator Fender Close Off
6. Passenger Flip-Up Windshield Close Off
7. Operator Flip-Up Windshield Close Off
8. Upper Windshield Close Off

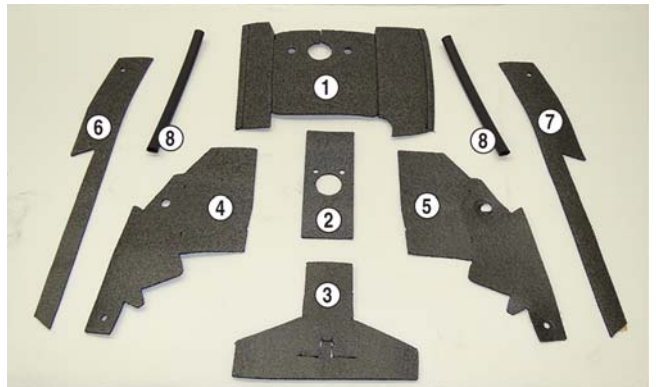

1. Remove both torx head screws under the left-side front fender. See Fig. 14.

Fig. 14



■ **NOTE:** Clean area with isopropyl rubbing alcohol and allow to dry. This process should be done at room temperature.

2. Remove the backing from the two adhesive strips from Fender Close-Off's and secure to the vehicle using the two screws removed in step 1. See Fig. 15.

Fig. 15



3. Press the adhesive strips against the vehicle to secure. Repeat for opposite side.
4. Install Steering Post Close-Off around the steering post and behind the dash. Secure using two push pins. See Fig. 16.

Fig. 16



5. Remove the two cap screws and the screw and nut securing the steering post lift support. See Fig. 17.

Fig. 17



6. Install Lift Support Close Off behind the dash; then install the existing screws. Tighten securely. See Fig. 18.

Fig. 18



7. Install Inner Panel Close-Off around the inside of the steering post shaft. See Fig. 19.

Fig. 19

