

ATV TIGER TRAX²

**Operator's Manual
Installation Instructions
Service Instructions
Replacement Parts List**



- **Track Assembly Kits (p/n 1436-881)**
- **Mounting Assembly Kits (p/n 1436-915)**

ARCTIC CAT[®]

SHARE OUR PASSION.™

Effective Date: October, 2013

LIMITED WARRANTY

Arctic Cat Inc. (hereinafter referred to as Arctic Cat) extends a limited warranty on each new Arctic Cat ATV Track Kit sold and initially set up/installed by an authorized Arctic Cat ATV dealer. Arctic Cat warrants that the product is free from defects in materials and workmanship for a period of one (1) year from the date of purchase by the original purchaser.

Arctic Cat warrants only the products it manufactures and/or sells and does not warrant that other products will function properly when used with an Arctic Cat ATV or will damage the ATV. Arctic Cat does not assume any liability for incidental or consequential damages.

Arctic Cat will repair or replace, at its own option, any parts that are found to be warrantable in material or workmanship. The repair work is required to be performed by an authorized Arctic Cat ATV dealer. Transportation charges will not be paid by Arctic Cat. Warranty applies only to products which have been properly assembled, adjusted, and operated in accordance with the instructions sent with the product. Warranty does not apply to any product of Arctic Cat that has been subject to alteration, misuse, abuse, improper assembly or installation, normal wear, or normal maintenance. The warranty is validated upon examination of said parts by Arctic Cat or an authorized Arctic Cat ATV dealer. Arctic Cat reserves the right to inspect such parts at its factory for final determination if warranty should apply.

In consideration of the foregoing, any implied warranty is limited in duration to the various warranty periods set forth. This warranty gives you specific legal rights, and you may also have other rights which vary from state to state or country to country. Some states do not allow limitations on how long an implied warranty lasts, so the above limitations may not apply to you.



The Safety Alert Symbol means ATTENTION! BE ALERT! YOUR SAFETY IS INVOLVED.



WARNING

Failure to follow WARNING instructions could result in severe injury or death to the ATV operator, a bystander, or a person inspecting or repairing the ATV.

CAUTION

A CAUTION indicates special precautions that must be taken to avoid damage to the ATV and/or the Tracks.

■NOTE:

A NOTE provides key information to make procedures easier or more clear.

Table of Contents

Operation	1
Safe Operating Practices.....	1
General Operation	1
Service Parts.....	4
Installation Instructions	8
Required Tools.....	8
Front Mounting Brackets.....	8
Front Track Kits.....	9
Rear Mounting Brackets	9
Rear Track Kits	10
Snow Deflector Panel Kit (p/n 1541-130)	11
Adjusting Components	12
Front Track Toe-In.....	12
Track Tension.....	12
Front Track Attack Angle.....	13
Rear Track	14
Break-In and Maintenance.....	14
Break-In Period.....	14
Maintenance	14
Maintenance Schedule	16
Replacement Procedures	17
Tracks	17
Sprocket	18
Plastic Guard.....	18
Main Axle or Main Axle Bearings	18
Wheel	18
Tensioner Cylinder.....	19
Tandem Assembly Nylon Bushing	19
Preparation for Storage	20
Preparation after Storage.....	20
Owner/Warranty Registration.....	21

Operation

Safe Operating Practices

■**NOTE:** Carefully read all items in the Safe Operating Practices section of this manual.

⚠ WARNING

Failure to observe the following Safe Operating Practices could result in serious injury and/or death.

Be aware with tracks installed, your ATV will have different driving characteristics than with wheels. Familiarize yourself with the ATV with tracks installed. With a track system installed, the ATV has new dimensions (wider, longer, and taller), it is heavier, and it has greater ground traction on hard terrain, but not on slippery ground such as ice or muddy clay. Braking distances and maneuverability are therefore affected. Installing this track system on a ATV reduces ATV speed by about 35%, but it does not affect loading or towing capacities.

1. Read the Operation and servicing instructions in this manual carefully.
2. Be thoroughly familiar with the controls and the proper use of the ATV with this equipment.
3. Only allow responsible adults who are familiar with the instructions to operate the ATV with this equipment. Never allow children to operate the ATV.
4. **NEVER CARRY PASSENGERS** while operating the ATV with this equipment installed unless yours is a TRV.
5. When cleaning, repairing, or inspecting, make certain that all moving parts have stopped. Shut off the engine.

⚠ WARNING

The warning decal visible on the side of each frame (see illustration) warns the operator about the danger presented by the sprocket and wheels while rotating the track. Watch for these components at all times.

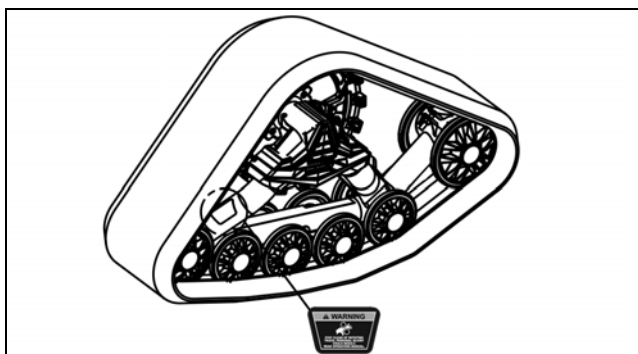

TT-001

6. Do not operate the ATV if the tracks have been damaged in any way. Inspect and repair as necessary.
7. Check all fasteners after three hours of use and after each repair or replacement of the track system components for tightness to be sure the equipment is in safe operating condition. See maintenance schedule.
8. Maintain or replace safety and instruction labels as necessary.

General Operation

⚠ WARNING

Always operate the ATV in 4WD mode; this significantly reduces the possibility of derailing in any conditions.

⚠ WARNING

Take into account that braking distance may increase. Locking the tracks by braking may cause a loss of control. Never try to make the tracks skid and only operate the ATV in 4WD mode.

⚠ WARNING

Never attempt to jump. Track systems were not designed to perform this type of riding behavior. Loss of control and/or breakage may occur with risk of serious injuries or death. ATV's equipped with tracks should not be used for racing, jumping, stunts, acrobatics, or any other application that may cause the ATV to lose contact with the ground.



ROV-366A

⚠ WARNING

There is a risk of serious injury if you try to touch the track system components with your hands or feet when the ATV is running. Your hands may get caught between the components. For this reason, always shut off the engine, remove the ignition key, and engage the hand brake if you must check the track system.

⚠ WARNING

All components of the track system, without exception, must be removed when the original wheels of the ATV are reinstalled. The wheeled ATV is not designed to be used with these components.

⚠ WARNING

A verification of the torque and adjustments must be performed after three hours of use and after each repair or replacement of the track system components.

⚠ WARNING

Steep slopes are reached more easily with tracks than with wheels, but that does not mean you can safely venture on them. The limitations are the same as those indicated in the Operator's Manual of your ATV.

⚠ WARNING

Do not change direction during steep descents. This can lead to a serious damage of the ATV's steering system and/or track systems. During a steep descent, it is best to keep the track pointed in a forward direction turning only when the ATV is on a flat ground to avoid causing a high amount of stress to components of the ATV and track system.



ROV-364A

⚠ WARNING

Avoid driving over obstacles such as large rocks, tree trunks, or steep ridges that could become lodged between the front and rear track systems immobilizing the ATV. It is best to bypass this type of obstacle.



ROV-363A



ROV-365A

⚠ WARNING

Never exceed the loading or towing capacities specified by your ATV's manufacturer on any type of terrain.

⚠ WARNING

When the ATV is loaded, the operator should significantly reduce speed and be extra careful on rough terrain.

⚠ WARNING

Snow and mud tend to conceal obstacles such as pits, branches, stumps, rocks, or fences. When they are not expected, even small obstacles can destabilize the driver and make the driver lose control of the ATV.

⚠ WARNING

Do not use the tracks as a step plate. The ATV could move and injure you.

⚠ WARNING

ATV speed should be reduced at all times. This track system does not have the same shock absorption and handling characteristics as tires.

⚠ WARNING

The driving characteristics of your ATV will change with the installation of the system. It is important to take the time to become familiar with the system.

⚠ WARNING

Tracks have more traction on the ground and may project stones, dirt, or other debris. Be aware of the proximity of people around you or following you.

⚠ WARNING

Adapt your driving style to surrounding conditions (weather, traffic, etc...) and to your driving abilities.

⚠ WARNING

Always follow the ATV manufacturer's safety rules and regulations.

CAUTION

Never perform sharp turns with the 4x4 differential lock engaged on high-traction terrain; doing so may cause damage to ATV drive system components. Some ATV's may not have a 4x4 differential unlock mode on the rear differential. For those ATV's, avoid the above mentioned situation by taking wider turns.

CAUTION

Two engine ratios are generally proposed (High/Low). The High ratio should be used only on flat and hard surfaces.

CAUTION

The rear of the track is not suitable for crossing large obstacles or rolling in the snow backward. Be careful when you perform any backward maneuver.

CAUTION

Driving through ruts over long distances can heat up the track and may drastically reduce its durability.

CAUTION

When towing, hauling, or digging out the ATV, do not attach anything to the tracks or the frame. The frame of your ATV usually has specific locations for this purpose.

CAUTION

Before using the ATV, inspect the ATV and track system and make sure no mud, snow, ice, or debris hamper the proper function of moving parts of the track system or ATV.

CAUTION

It is the driver's responsibility to verify the air intake of the ATV is well adapted to weather conditions and is not blocked by snow accumulation.

CAUTION

Always have the ATV in 4WD when operating with the track kit. Operating in 2WD will affect performance and may damage the ATV.

Service Parts

This section contains replacement part numbers of all components of the Track Kits. To obtain replacement parts, please contact your Arctic Cat ATV Dealer for service. When ordering parts, please have the part number and quantity you are looking for and the model and serial number of the Track on hand.

Front Track Kit Assembly: (p/n 1541-109 Right) - (p/n 1541-108 Left)

■NOTE: The Qty column reflects the total number of components in both kits.

Ref. No.	p/n	Qty	Description	Ref. No.	p/n	Qty	Description
1	2441-600	2	Track	17	2441-618	2	Carriage Bolt (M10-1.5 x 50 mm)
2	2441-602	1	Right Main Frame	18	2441-619	8	Nyloc Nut (M8-1.25)
	2441-601	1	Left Main Frame	19	2441-620	2	Nyloc Nut (M10-1.5)
3	2441-603	2	Plastic Protector	20	2441-621	8	Flat Washer (M8 x 4 mm)
4	2441-604	2	Sprocket	21	2441-622	24	Flat Washer (M10 x 4 mm)
5	2441-605	16	Wheel (144 mm)	22	2441-623	24	Wheel Back Washer
6	2441-606	4	Wheel (190 mm)	23	2441-624	2	Main Axle Spacer
7	2441-607	2	Main Axle	24	2441-625	2	Snap Ring (Small)
8	2441-608	24	Wheel Cap	25	2441-626	2	Snap Ring (Large)
9	2441-609	2	Front Tensioner Can	26	2441-627	4	Wheel (165 mm)
10	2441-611	1	Right Frame Decal	27	2441-628	4	Tandem Assembly
	2441-610	1	Left Frame Decal	28	2441-629	2	Tandem Shaft
11	2441-612	2	Warning Decal	29	2441-630	4	Tandem Plastic Plug
12	2441-613	4	Bearing	30	2441-631	4	Tandem Nylon Bushing
13	2441-614	2	Main Axle Seal	31	2441-632	4	Tandem O-Ring
14	2441-615	12	Torx Screw (13 mm)	32	2441-633	4	Flat Washer (M8)
15	2441-616	8	Cap Screw (M8-1.25 x 35 mm)	33	2441-634	4	Socket Head Cap Screw
16	2441-617	22	Cap Screw (M10-1.5 x 25 mm)				

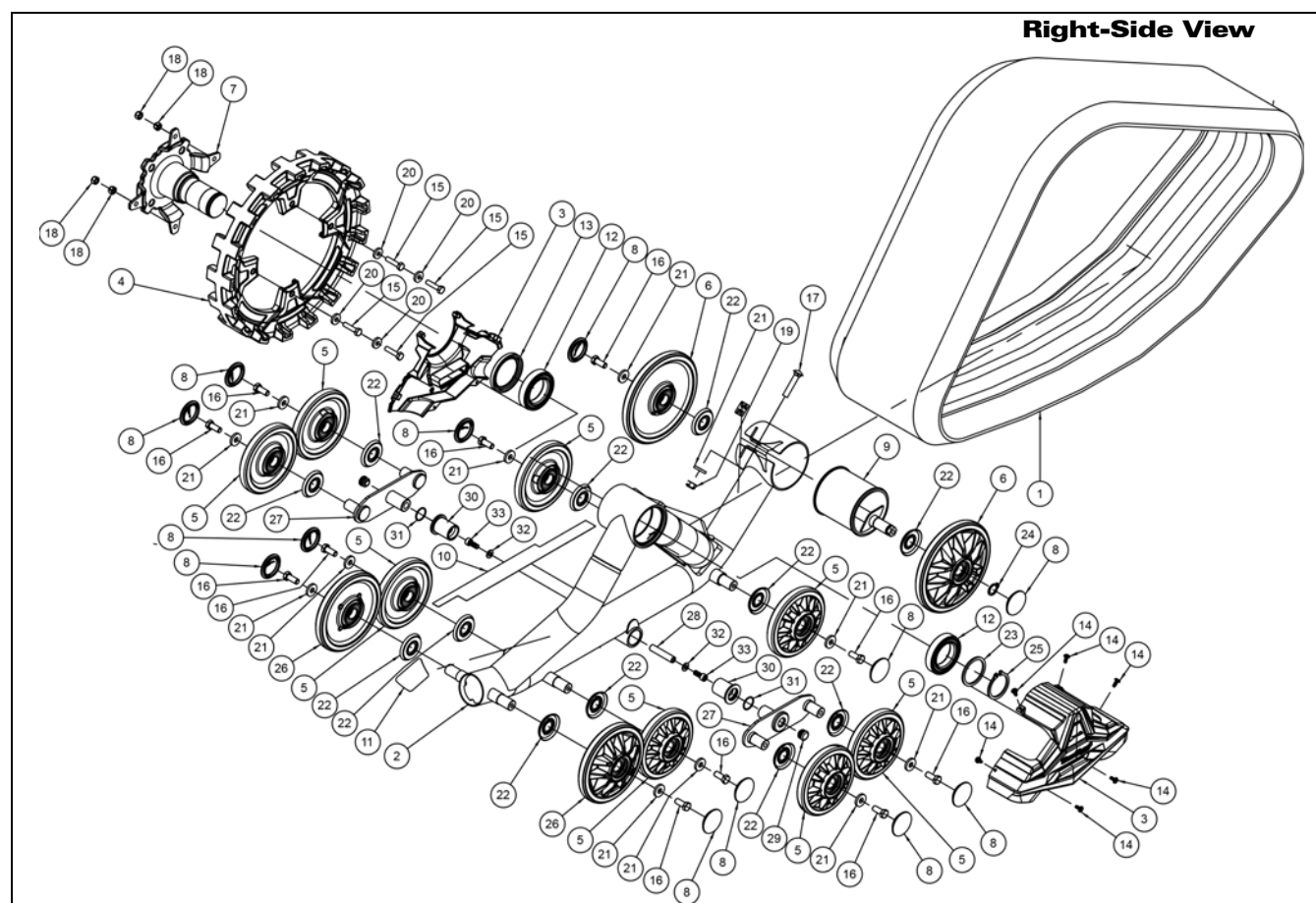

Rear Track Kit Assembly: (p/n 1541-111) Right - (p/n 1541-110) Left

■NOTE: The Qty column reflects the total number of components in both kits.

Ref. No.	p/n	Qty	Description	Ref. No.	p/n	Qty	Description
1	2441-635	2	Track	14	2441-615	12	Torx Screw (13 mm)
2	2441-637	1	Right Main Frame	15	2441-616	8	Cap Screw (M8-1.25 x 35 mm)
	2441-636	1	Left Main Frame	16	2441-617	22	Cap Screw (M10-1.25 x 25 mm)
3	2441-603	2	Plastic Protector Assembly	17	2441-618	2	Carriage Bolt (M10-1.5)
4	2441-604	2	Sprocket	18	2441-619	8	Nyloc Nut (M8-1.25)
5	2441-605	16	Wheel (144 mm)	19	2441-620	2	Nyloc Nut (M10-1.5)
6	2441-606	8	Wheel (190 mm)	20	2441-621	8	Flat Washer (M8 x 4 mm)
7	2441-607	2	Main Axle	21	2441-622	24	Flat Washer (M10 x 4 mm)
8	2441-608	24	Wheel Cap	22	2441-623	24	Wheel Back Washer
9	2441-644	2	Rear Tensioning Can	23	2441-624	2	Main Axle Spacer
10	2441-610	1	Right Side Frame Decal	24	2441-625	2	Snap Ring (Small)
	2441-611	1	Left Side Frame Decal	25	2441-626	2	Snap Ring (Large)
11	2441-612	2	Warning Decal				
12	2441-613	4	Bearing				
13	2441-614	2	Main Axle Seal				

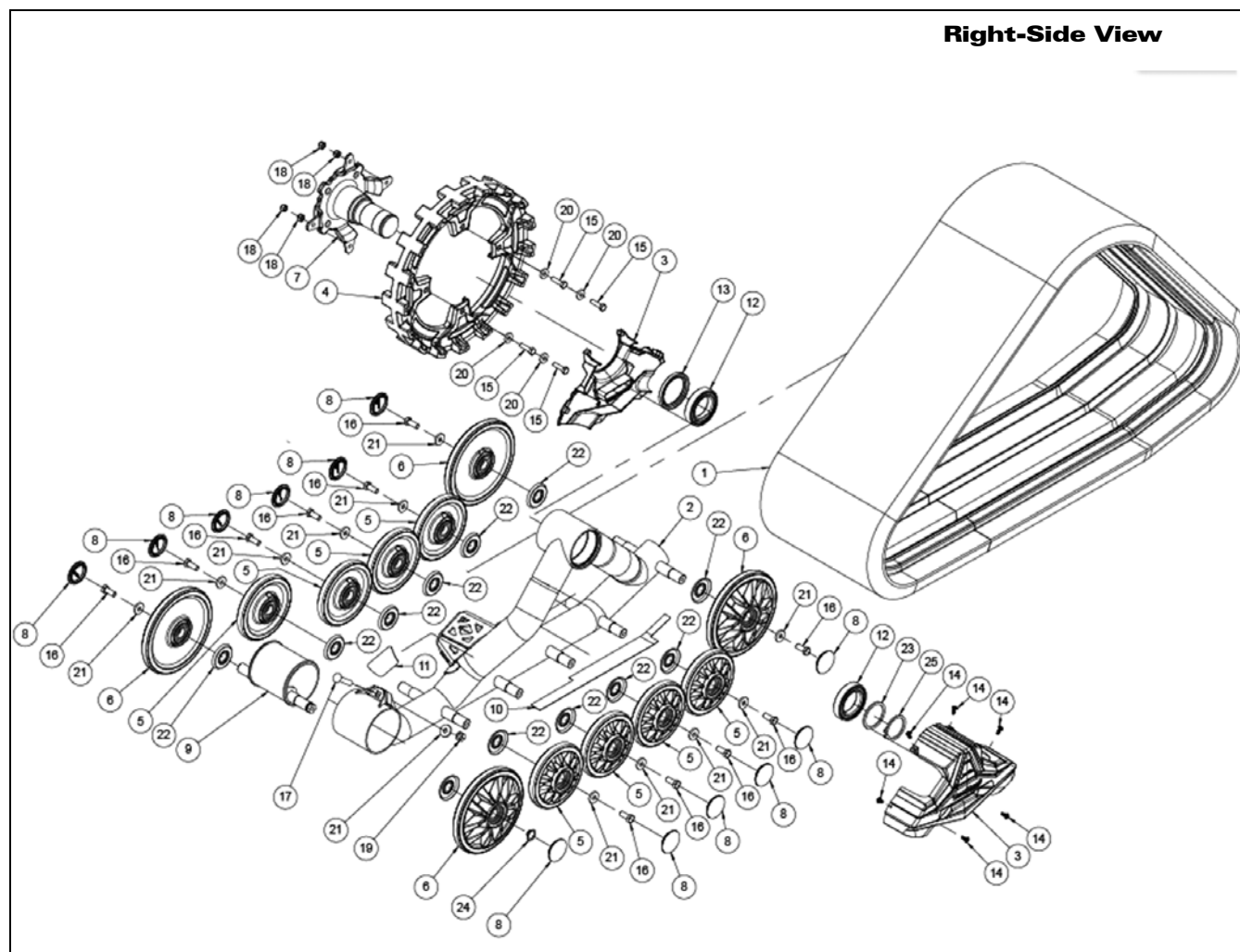

TT-034

Front Mounting Bracket Kit Assembly: (p/n 1541-117) Right - (p/n 1541-116) Left

■NOTE: The Qty column reflects the total number of components in both kits.

Ref. No.	p/n	Qty	Description	Ref. No.	p/n	Qty	Description
1	2441-731	1	Right Side Lower Mounting Plate	A	2441-740	2	Threaded Rod (M16-2 x 310 mm)
	2441-730	1	Left Side Lower Mounting Plate	B	2441-741	2	Rod End (M16 x 2)
2	2441-732	2	Spacer	C	2441-742	2	Slider Sleeve
3	2441-734	1	Right Side Decal	D	2441-743	2	Spring
	2441-733	1	Left Side Decal	E	2441-744	2	Spring Washer (Rubber Side)
4	2441-735	2	Hex Nylon Nut (M12-1.75)	F	2441-745	2	Spring Washer (Nut Side)
5	2441-736	2	Flange Nylon Nut (M12-1.75)	G	2441-746	2	Thick Washer
6	2441-737	1	Carriage Bolt (M12-1.75 x 65 mm)	H	2441-747	2	Rubber Damper (13 mm)
7	2441-739	1	Right Side Upper Mounting Plate	I	2441-748	2	Rubber Damper (19 mm)
	2441-738	1	Left Side Upper Mounting Plate	J	2441-749	2	Hex Nut (M16-2)
				K	2441-750	4	Hex Nut (M16-2 (Thin))
				L	2441-751	2	Hex Nylon Nut (M16-2)

■NOTE: A-L are part of the Front ATV Anti-Rotation Arm Kit (p/n 1541-126).

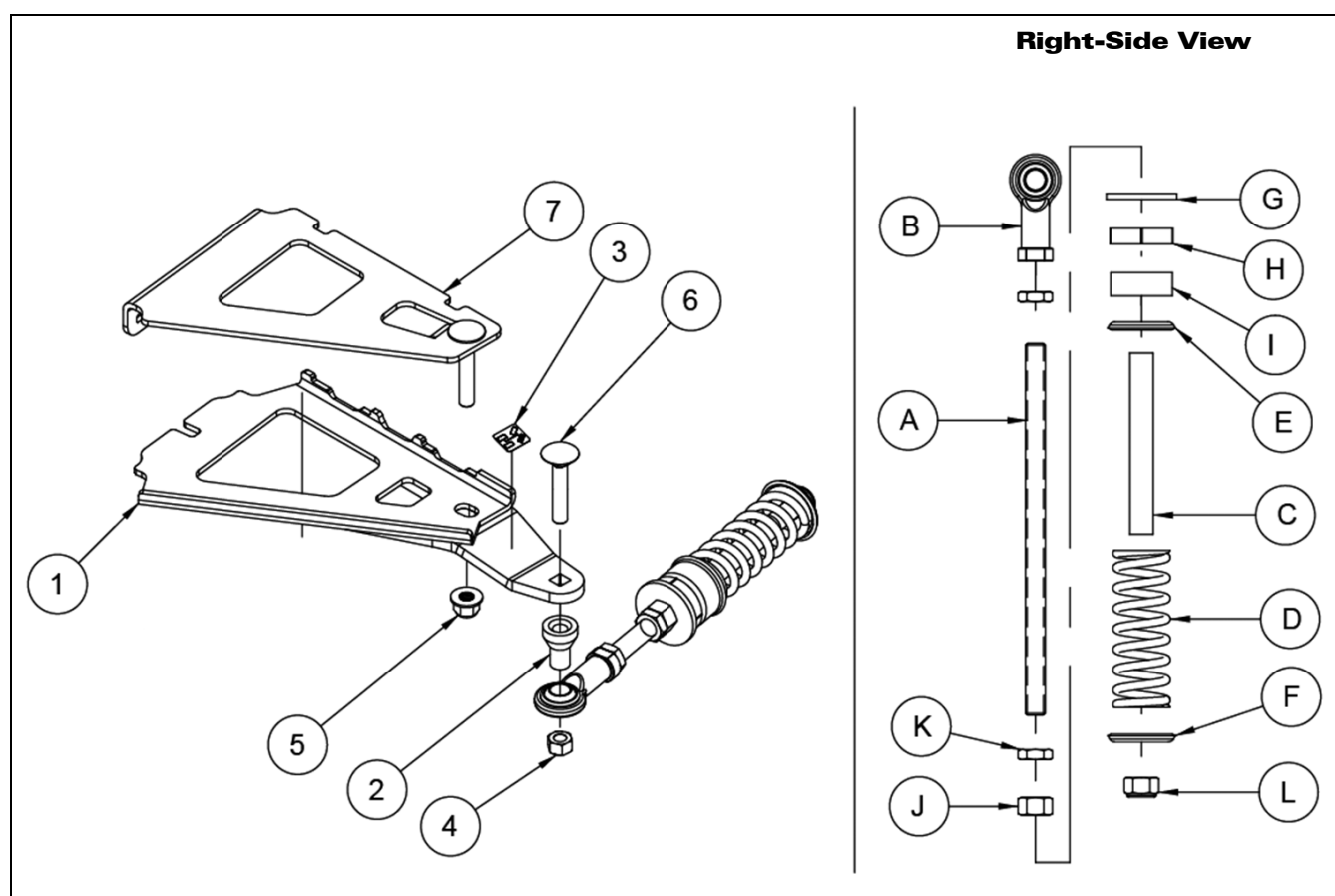

TT-041

Rear Mounting Bracket Kit Assembly: (p/n 1541-119) Right - (p/n 1541-118) Left

■NOTE: The Qty column reflects the total number of components in both kits.

Ref. No.	p/n	Qty	Description	Ref. No.	p/n	Qty	Description
1	2441-753	1	Right Side Mounting Plate	A	2441-764	2	Threaded Rod (M16-2 x 262 mm)
	2441-752	1	Left Side Mounting Plate	B	2441-741	2	Rod End (M16 x 2)
2	2441-754	4	Spacer	C	2441-766	2	Slider Sleeve
3	2441-756	1	Right Side Decal	D	2441-767	2	Spring
	2441-755	1	Left Side Decal	E	2441-768	2	Spring Washer (Rubber Side)
4	2441-735	2	Hex Nylon Nut (M12-1.75)	F	2441-769	2	Spring Washer (Nut Side)
5	2441-758	2	Hex Nylon Nut (M10-1.5)	G	2441-770	2	Conical Washer
6	2441-759	4	Hex Nylon Nut (M8-1.25)	H	2441-748	4	Rubber Damper (19 mm)
7	2441-760	2	Carriage Bolt (M12-1.75 x 75 mm)	I	2441-772	2	Anti-Rotation Arm Bracket
8	2441-761	2	Hex Bolt (M10-1.5 x 110 mm)	J	2441-749	2	Hex Nut (M16-2)
9	2441-762	2	U-Bolt	K	2441-750	4	Hex Nut (M16-2 (Thin))
10	2441-633	4	Flat Washer (M8)	L	2441-751	2	Hex Nylon Nut (M16-2)
				M	2441-617	4	Hex Bolt (M10-1.5 x 30 mm)

■NOTE: A-M are part of the Rear ATV Anti-Rotation Arm Kit (p/n 1541-126).

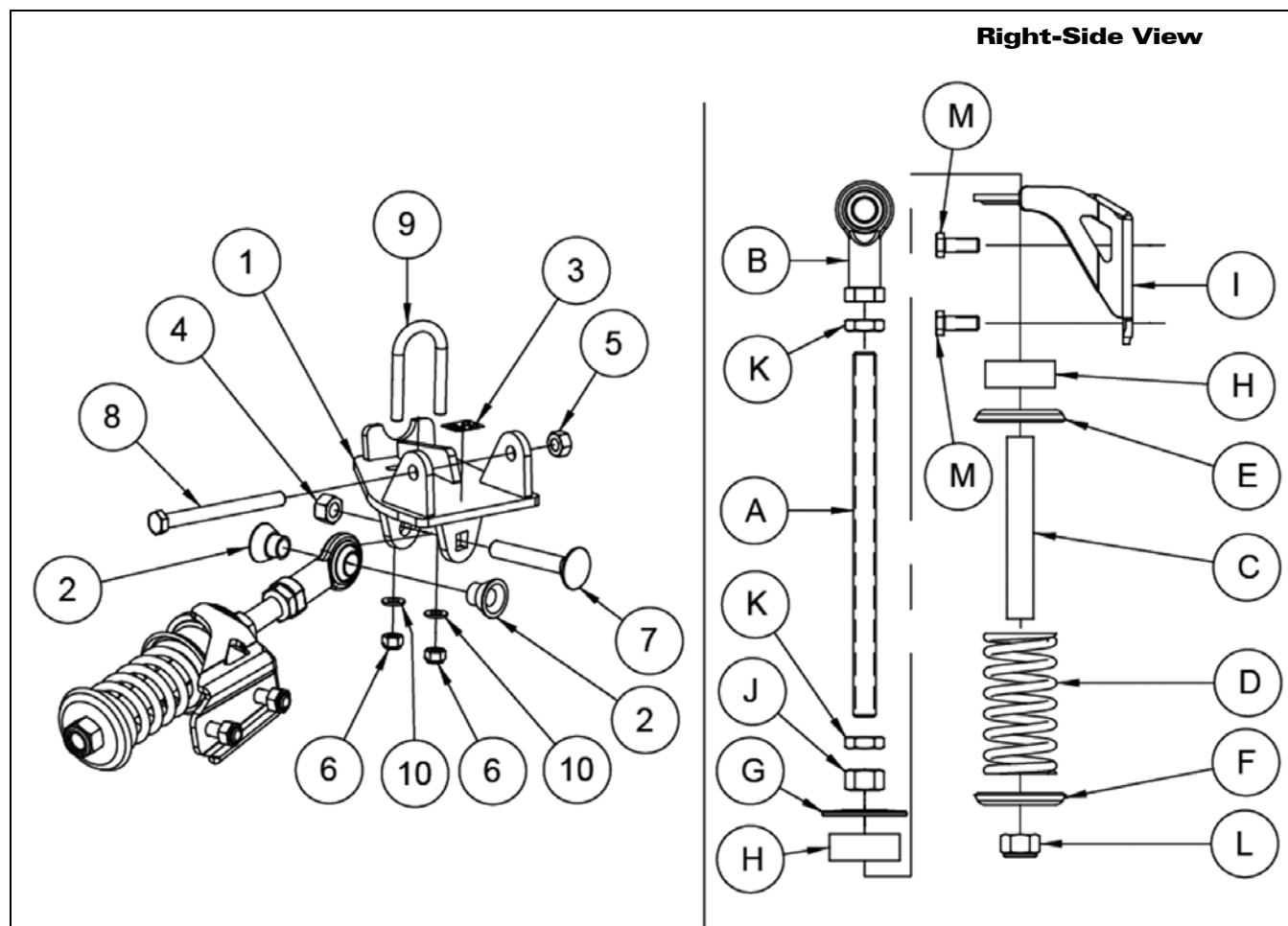

TT-042

Installation Instructions

WARNING

1. The ATV must be immobilized, in 2WD mode, in neutral, and the engine shut off and cooled.
2. Make sure the ATV is secured in place by a system dedicated to this use (jack stands and hoist) and that it lies on or is fastened to areas that are not likely to break, bend, or slip. A hydraulic jack is not safe, nor is a log. The ATV must not be able to move.
3. Always wear safety glasses during installation, adjustment, or repair.
4. Do not over-tighten cap screws or nuts. Some components may be subject to deformation. If cap screws are too tight, safety could be compromised.
5. Please read warnings and instructions and be sure that you understand them.

■NOTE: For a complete illustration and list of components, see pages 4-7 of this manual.

Required Tools

- Torque Wrench with a maximum torque of 65 ft-lb
- 17 mm Deep Socket
- 13 mm and 17 mm Socket Wrenches w/6-in. Extension
- 13 mm, 17 mm, and 24 mm Wrenches*
- Crescent (Adjustable) Wrench*
- Snap Ring Pliers
- Flathead Screwdriver
- Measuring Tapes
- ATV Lift and Support Stands
- T25 Torx Bit

* During trips always carry the 13-mm and 17-mm sockets and a crescent (adjustable) wrench.

■NOTE: Each track is labeled on the actual frame and brackets and indicate where the tracks are placed: Front Left, Front Right, Rear Left, and Rear Right.

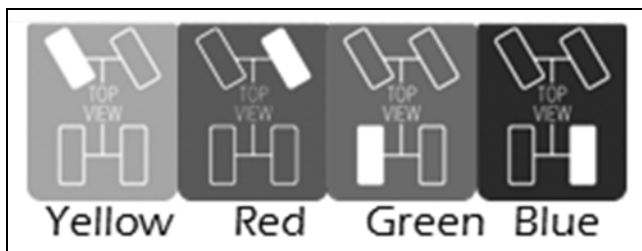

TT-002

■NOTE: See an authorized Arctic Cat ATV dealer for the required Clutch Kit (p/n 1436-614) 2007-2014 550, 650, 700, TBX, TRV (excluding Mud Pro and Diesel) or Clutch Kit (p/n 1436-333) 1000 FIS and TRV models (excluding Mud Pro) for your ATV.

Front Mounting Brackets

■NOTE: This procedure is appropriate for both left and right front track kits.

■NOTE: The installation requires that the ATV be in 2WD and shifted into neutral.

1. Remove the components from the shipping package; then verify that there are no missing or damaged components.
2. Place the ATV on a flat surface, block the rear wheels (if applicable), and raise the front of the ATV using a support stand.
3. Remove the front wheels.
4. Place the top bracket on the lower A-arm; then slide the lower front A-arm bracket inside the top bracket slot.

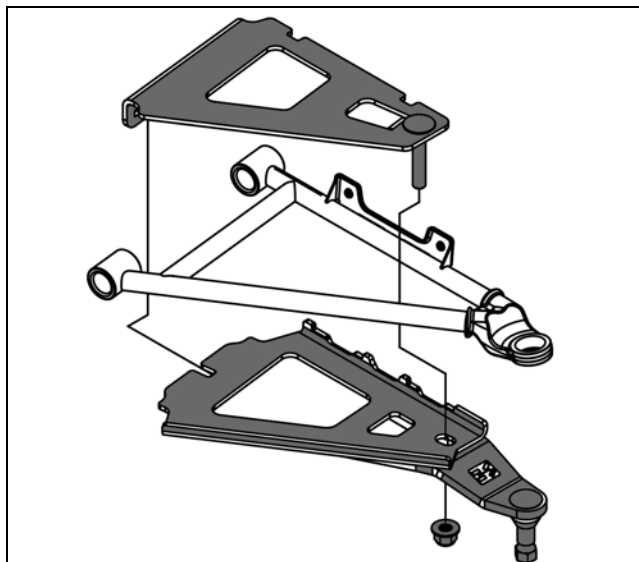

TT-003

5. Lean the bottom bracket against the A-arm bottom. The top plate will open up from the A-arm.

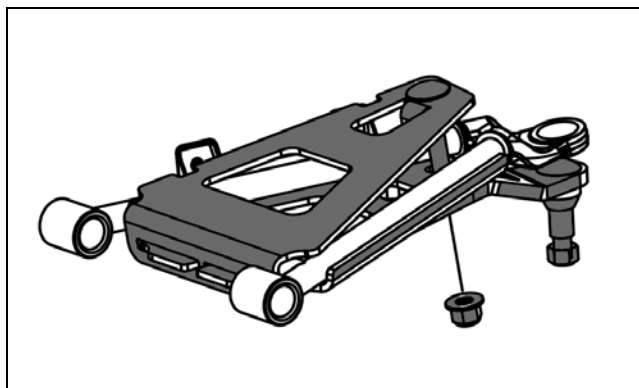

TT-004

6. Install the M12 carriage bolt through both upper and lower brackets and secure using a flanged nyloc nut. Tighten to 61 ft-lb.

⚠ WARNING

Use care in positioning the mounting brackets. Incorrectly positioning the mounting brackets could make driving riskier as well as lead to breakage to the ATV and a loss of control or serious injury may occur.

7. Repeat steps 4-6 for the opposite side.

■**NOTE:** The installation of the anti-rotation arm to the mounting bracket must be done before the installation of the track system on the ATV.

8. From the anti-rotation arm assembly, remove the M16-2.0 nylon nut (A), spring washer (B), spring (C), spring washer (D) sliding on the steel slider sleeve, and rubber washer (E).

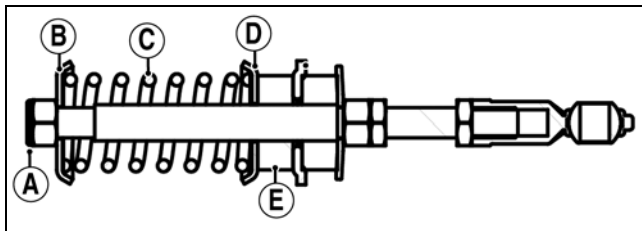

TT-008A

9. Insert the anti-rotation arm into the hole provided for this purpose onto the front track assembly.
10. Replace the components removed in step 8 in the same order. Repeat for the opposite side.

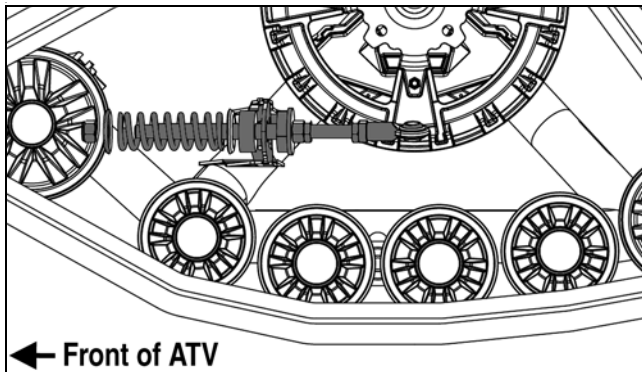

TT-006A

Front Track Kits

CAUTION

Care must be taken that the front left track kit is installed on the left side and the front right track kit is installed on the right side (see color-coded sticker for proper identification).

1. Identify which frame corresponds to the wheel removed using the color images (from page 8).

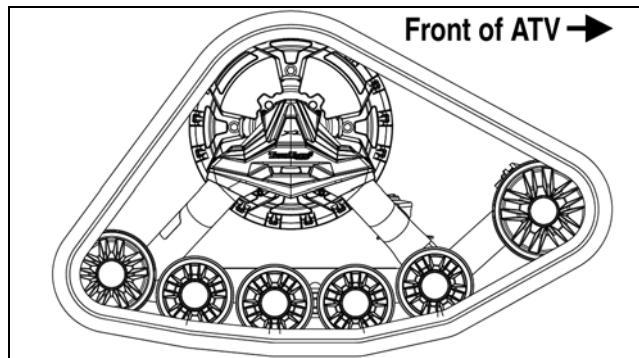

TT-012A

■**NOTE:** Clean the wheel and hubs before installing wheels or track kits.

2. Align the wheel studs with the holes in the track assembly; then secure the track assembly using new provided wheel lug nuts. Tighten the lug nuts in a crisscross pattern in three steps to 80 ft-lb.



TT-013

3. Insert the rod end of the anti-rotation arm into the M12 carriage bolt of the A-arm bracket. Secure using M12 nut and tighten to 61 ft-lb.

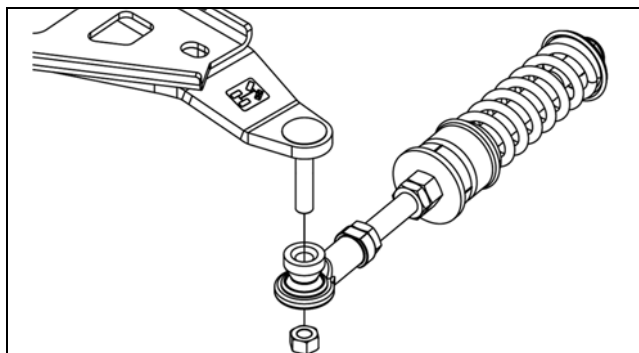

TT-043

■**NOTE:** It may be necessary to move the track frame around to align the hole and the carriage bolt.

4. Repeat steps 1-3 for opposite side.

Rear Mounting Brackets

■**This procedure is appropriate for both left and right rear track kits.**

■**NOTE:** The installation requires that the ATV be in 2WD and shifted into neutral.

1. Remove the components from the shipping package; then verify that there are no missing or damaged components.
2. Place the ATV on a flat surface and raise the rear of the ATV using a support stand.
3. Remove the rear wheels; then remove and retain the rear boot guards.
4. Remove the cap screw and nut securing the lower A-arm to the rear knuckle assembly; then remove the cap screw securing the rear suspension bracket.

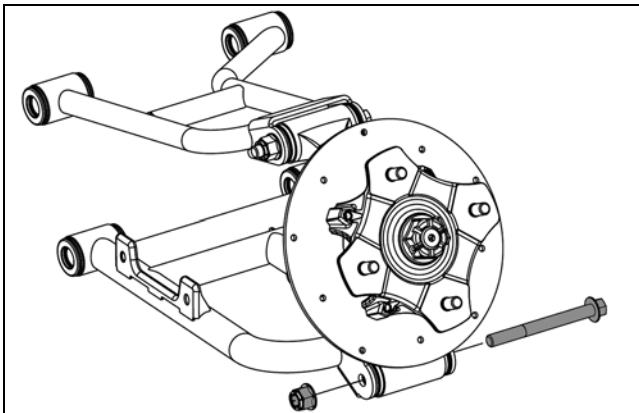

TT-044

5. Position the rear suspension bracket (A) in place and loosely secure it using an M10-1.5 x 140 mm cap screw (B) and the M10 nylon nut (C).

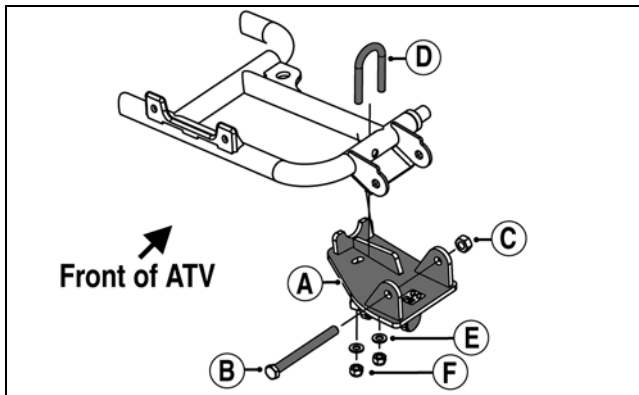

TT-007A

6. Position the M8 U-bolt (D) and secure it using the two M8 flat washers (E) and two M8 nuts (F). Tighten the M10 nylon nut to 34 ft-lb and the two M8 nuts to 17 ft-lb.
7. Repeat steps 1-6 for the opposite side.

■**NOTE:** The installation of the anti-rotation arm must be done before the installation of the track system on the ATV.

8. From the rear anti-rotation arm assembly, remove the M16-2.0 nylon nut (A), spring washer (B), spring (C), spring washer (D) sliding on the steel slider sleeve, and rubber washer (E).

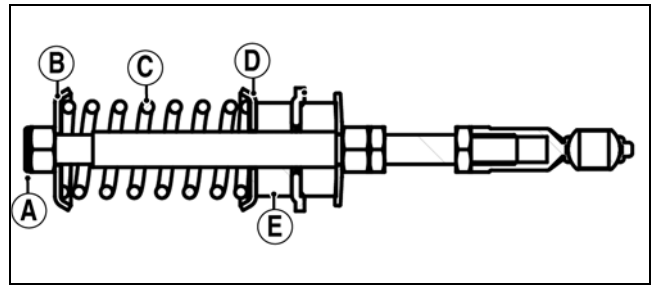

TT-008A

9. Install the mounting bracket onto track assembly using two M10 x 25 mm cap screws. Tighten to 34 ft-lb.

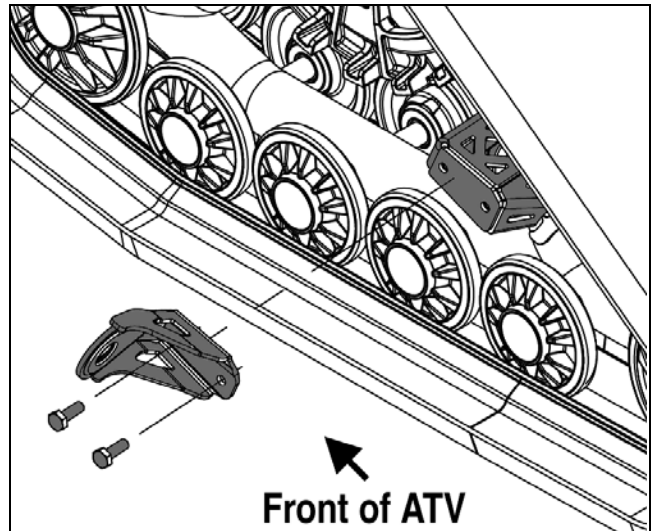

TT-010A

10. Insert the anti-rotation arm into the hole of the installed mounting bracket.
11. Replace the components removed in step 8 in the same order.

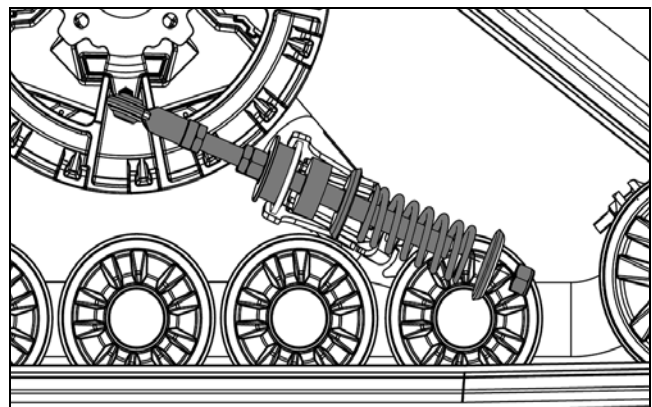

TT-011

Rear Track Kits

CAUTION

Care must be taken that the front left track kit is installed on the left side and the front right track kit is installed on the right side (see color-coded sticker for proper identification).

1. Identify which frame corresponds to the wheel removed using the color images (from page 8).

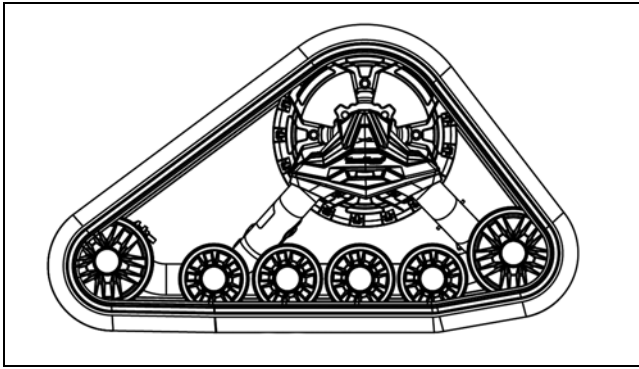

TT-015

■NOTE: Clean the wheel and hubs before installing wheels or track kits.

- Align the wheel studs with the holes in the track assembly; then secure the track assembly using new provided wheel lug nuts. Tighten the lug nuts in a crisscross pattern in three steps to 80 ft-lb.



TT-013

- Insert the rod end of the anti-rotation arm into the M12 carriage bolt of the A-arm bracket. Secure using M12 nut. Tighten to 61 ft-lb.

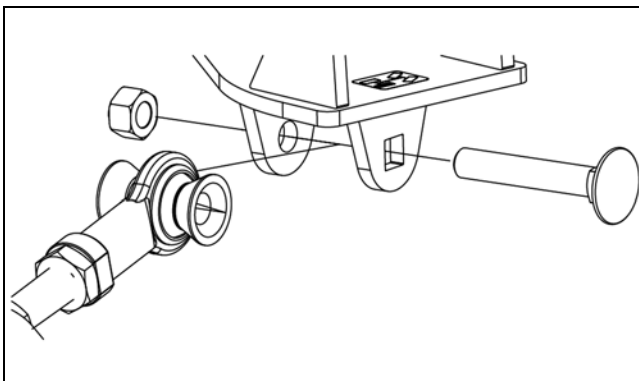

TT-016

■NOTE: It may be necessary to move the track frame around to align the hole and the carriage bolt.

- Repeat steps 1-3 for opposite side.

Snow Deflector Panel Kit (p/n 1541-130)

■NOTE: This kit is recommended for use in snow conditions only.

CAUTION

USE IN SNOW CONDITIONS ONLY. Failure to remove in non-snow or warm conditions may cause the ATV to overheat resulting in engine damage.

- Place the front deflector panels in position and secure with cable ties as needed.
- If the ATV does not have rear splash deflectors in the front wheel well area, install the rear deflector panels as shown. Use cable ties as needed.



Front of Vehicle - Front Deflector

TT-057

■NOTE: Snow deflector panels have pre-formed cutouts that may need to be removed for some ATV's.

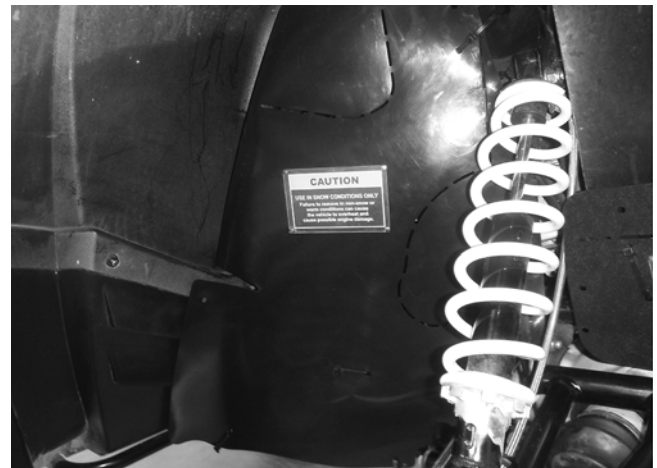

Front of Vehicle - Rear Deflector

TT-059A

Adjusting Components

Front Track Toe-In

WARNING

Misalignment of steering or improper tightening of steering components may lead to loss of control of the ATV. During the break-in period, the alignment may change and must be verified.

■NOTE: Adjustments can be made by the ATV owner if qualified to do so. If the owner does not feel qualified, take the ATV to an authorized Arctic Cat ATV dealer for this service at the expense of the owner/operator.

WARNING

ALWAYS verify all adjustments made, and that they are identical between the right and left after test riding the ATV. These adjustments must be made on a flat surface on grade. Improper or non-verified adjustments can reduce performance and create premature wear of certain components. Make sure the handlebar is not turning by itself during a turn or when braking. If this is the case, the handlebar could rotate suddenly when you do not expect it and you could be ejected from the ATV posing a risk of serious injury.

WARNING

If adjustments to the front anti-rotation require that the rod end must be unscrewed, make sure a section of at least 25 mm (1 inch) of the threaded stud remains inside; otherwise tearing of threads, loss of control, and injuries could result.

■NOTE: This procedure is appropriate for both the front right and front left tracks.

1. With all four tracks installed on the ATV, place the ATV on a flat surface with the ATV in 2WD and in neutral.
2. To check toe-in, push the front of the tracks towards each other. Next, measure the length difference. The length has to be taken on the top of the front wheels. The front dimension should be same or greater by 1/4-in. than the rear dimension.



TT-031A

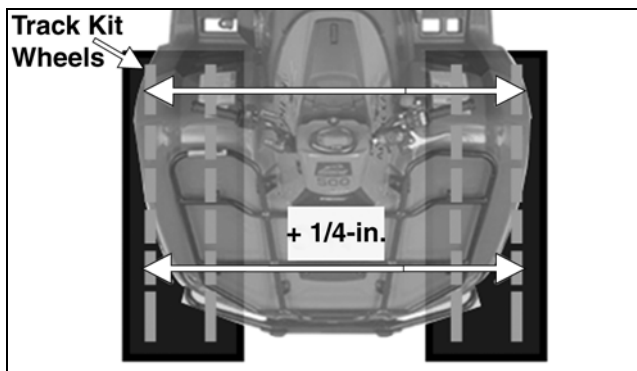

TT-032A



TT-047

3. If toe-in is not correct, refer to the appropriate Arctic Cat ATV Service Manual for detailed instructions on how to adjust toe-in.

Track Tension

WARNING

If the tightening bolt of the tensioner is incorrectly tightened, the track could slacken and cause loss of control.

CAUTION

A track that is too tight may cause a loss of performance or result in damage to some components.

Tracks must have similar tensions so they do not affect driving.

1. Lift the track above the ground during the tensioning operation to ensure proper tension.
2. Remove the wheel cap on the front tensioner wheels with a flathead screwdriver.

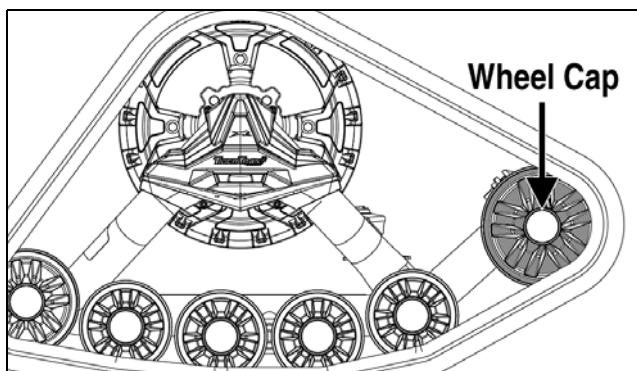

TT-056A

- Loosen the nut to release the tension of the cylinder.

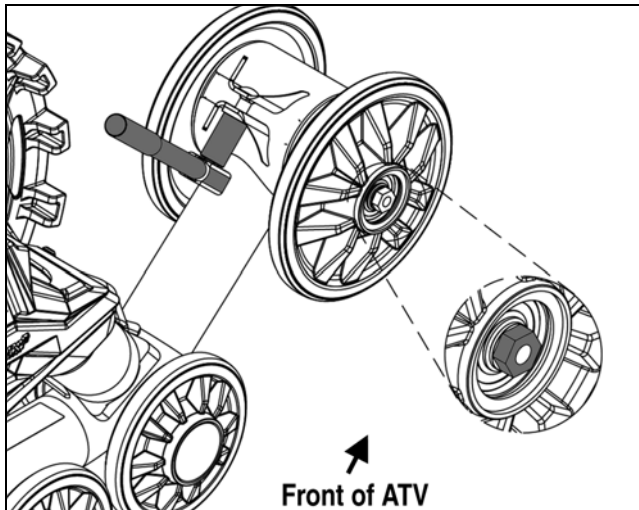

TT-027A

- Using a 17 mm deep socket, tighten the outer nut to 36 ft-lb.

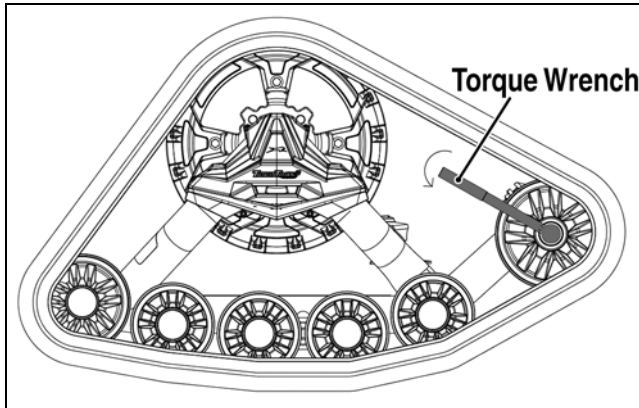

TT-026A

■NOTE: Tension is applied by turning the wrench counter-clockwise for the front right and rear left track and clockwise for the front left and right rear track.

- Make sure the tensioner cylinder is in place by reapplying the torque more than once.

■NOTE: Verify the track is tensioned correctly by ensuring the front track sticks to all wheels without allowing a finger to be slipped between the track and the wheels. For the rear only, the track should have a gap of $1/4 \pm 1/8$ in. with the center wheel.

■NOTE: If appropriate tension is not achievable, wash the mechanism under running water with the screw fully loosened; then wipe it and test it again (see Replacement Procedures - Tensioner Cylinder).

- While maintaining tension using the torque wrench, tighten the lock nut to 30 ft-lb.



TT-055

Front Track Attack Angle

- The anti-rotation arms are pre-set.
- Move the tracks left to right; then verify the height of the rear wheels of the front tracks are (from top of the wheel to the ground) 9 in. $\pm 1/4$ in.



TT-036A

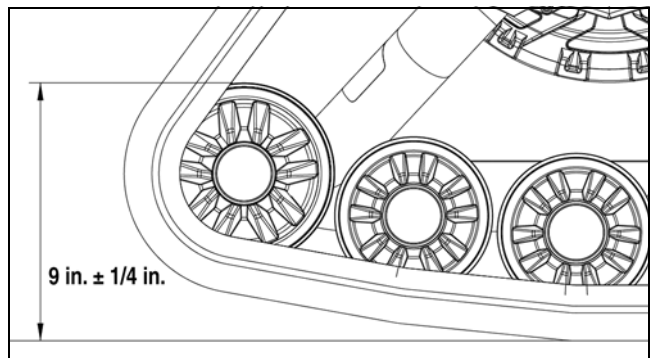

TT-030A

If the rear wheel of the track kit is not at a height of 9 in. $\pm 1/4$ in. from the ground, proceed to steps 3-7.

- If the wheel is lower than specified, loosen the lock nut (A) and nut (B) (the anti-rotation spring will push the wheel up by rotating the track kit) until the rear wheel is correctly positioned.

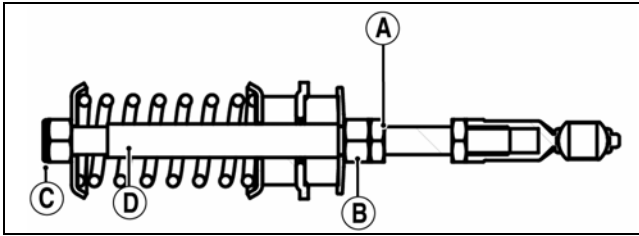

TT-008B

4. If the wheel is higher than specified, loosen the nyloc nut (C) (the nut must remain on the rod); then tighten the nut (B) until the rear wheel is correctly positioned.
5. Tighten the M16 nyloc nut (C) until the steel slide (D) is secure between nuts (C) and (B). Tighten to 60 ft-lb.
6. Tighten the lock nut (A) against the nut (B).

Rear Track

1. The anti-rotation arm is pre-set.
2. The ATV must be on a flat surface.

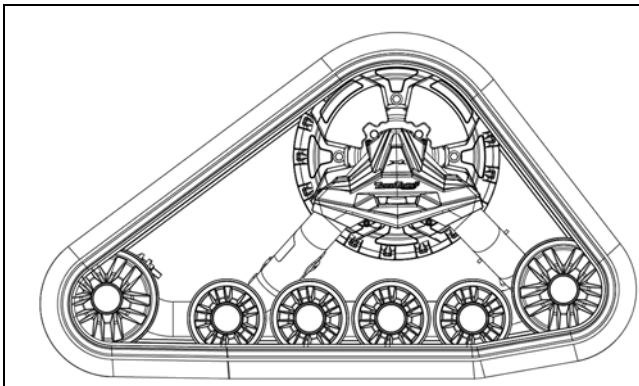

TT-028

3. If the tracks are not flat on the ground, proceed to steps 4-9.
4. Make sure the rubber washers of the anti-rotation arms are not tightened on one side or the other of the support and the steel slide sticks out from the rubber washers.
5. Tighten the rod end and the lock nut (C) using a 24 mm wrench and crescent wrench.

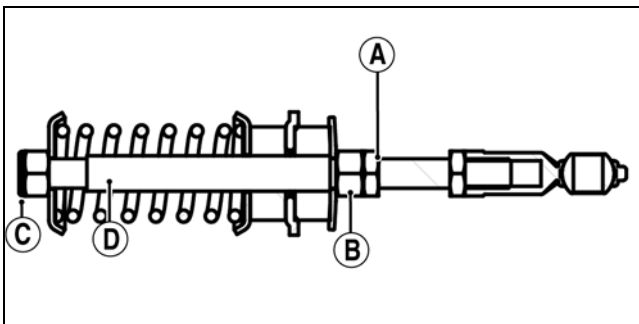

TT-008A

6. Tighten the nut (B) towards the rubber damper until track movement is detected.

7. Tighten the lock nut (A) until the steel slide (D) is secure between the nuts (C) and (B). Tighten to 60 ft-lb.

8. Tighten the lock nut (A) against the nut (B).

Break-In and Maintenance

Break-In Period

■ **NOTE:** A break-in period is required after each track replacement.

⚠ WARNING

When using the track system for the first time, drive on familiar ground at low speed by making turns in both directions to ensure the installation was performed correctly and to become familiar with the new driving style.

After three hours or 50 miles of use, verify all cap screws used to install the track kit have retained their torque specifications. Also inspect track tension by verifying torque specifications of the tensioner cylinder and visually inspect all moving and wear components.

Maintenance

⚠ WARNING

1. Annually perform a complete inspection.
2. It is the owner's responsibility to enforce the inspection and maintenance program; otherwise the use of the ATV could be dangerous.
3. A damaged ATV and/or track system are dangerous for the driver and the surroundings.
4. Inspections must be conducted once the engine is shut off and the ATV is safely immobilized.
5. Perform a visual inspection of components before each use.
6. Before any inspection and use, ensure no mud, snow, ice, or debris hamper the proper functioning of moving parts of the track system or ATV.
7. Check the level of tightening and the various adjustments after three hours of use and after each repair or replacement of the track system components.
8. The functioning of the track tensioner consists of tightening a cylinder with an eccentric axis. If the screw loosens, the track will eventually slacken and de-track. It is important to have a tight torque without exceeding the specification of 30 ft-lb \pm 3.
9. The arm of the anti-rotation system is the element that stabilizes driving and prevents tracks from turning around the main axles. Components must be in good condition and must not present any play when they are inspected on a flat surface and the ATV is without a load. Replace the rod end linking the arm attached to the brackets if there is significant play.

CAUTION

Driving with a component in bad condition damages other components.

Never use a solvent to clean track assemblies: solvents can cause rapid deterioration of rubber and plastic. Use only soapy water to clean.

1. The wheel bearings are sealed and are not greaseable. In the long run, water can seep into their housing and lead to corrosion. Such corrosion can sometimes make wheels difficult to rotate after a period of non-use. Rolling a few yards will un-jam the wheels and make them usable. If they do not un-jam, replace the bearings or wheel as necessary.
2. By cleaning your ATV and track system after each use, you make sure that no mud, snow, ice, or debris interferes with moving parts, and will make the next inspection easier.
3. Bolts are visible on the brackets, sprocket, track tensioner and main axles (ATV nuts). These should be checked regularly to ensure correct torque.
4. Take care to clean contact surfaces between the main axles of the ATV and those of the tracks.
5. The use of the track system on rough terrain greatly increases the strain on ATV components including the suspension and drive system. Any play or breakage of one of these parts can cause related parts to break.
6. The air filter tends to get dirty faster when using tracks (powdery snow, debris, dust, etc.). Clean it frequently. Some models are more efficient than others; for more information see your Arctic Cat ATV dealer.
7. Driving on surfaces with sharp edges (metallic debris, steel ramps, rocks, pointed branches, etc.) accelerates the creation of cracks, holes, and wear of the track.
8. Riding on uneven surfaces (convex, concave, or with ruts) over long periods tends to wear tracks faster and unevenly.
9. It is not advisable to install studs on the tracks because the tracks, wheels, and sprockets may be damaged.

Maintenance Schedule

Item	During Installation	After break-in period (3 h/75 km)	Before the season	Before each Trip	Every 20 hours of use	After of the season
Visible Cap Screws		Tighten	Tighten		Tighten	
Wheel Lug Nuts	Tighten	Tighten		Tighten		
Sprocket	Tighten	Tighten	Tighten Inspect & clean, adjust, replace as necessary			
Tensioner	Tighten	Tighten	Tighten Inspect & clean, adjust, replace as necessary	Inspect & clean, adjust, replace as necessary	Inspect & clean, adjust, replace as necessary	
Mounting Bracket and Anti-Rotation Bracket	Tighten	Tighten	Inspect & clean, adjust, lubricate, replace as necessary	Inspect & clean, adjust, lubricate, replace as necessary	Inspect & clean, adjust, lubricate, replace as necessary	
Attack Angle Adjustment	Inspect, clean, and adjust as necessary	Inspect, clean, and adjust as necessary	Inspect, clean, and adjust as necessary			
Anti-Rotation System Arm	Tighten	Tighten	Tighten Inspect & clean, adjust, lubricate, replace as necessary	Inspect & clean, adjust, lubricate, replace as necessary	Inspect & clean, adjust, lubricate, replace as necessary	
Track Alignment	Inspect and adjust as necessary	Inspect and adjust as necessary		Inspect and adjust as necessary		
Track Tension	Inspect and adjust as necessary	Inspect and adjust as necessary	Inspect and adjust as necessary	Inspect and adjust as necessary		
Track Wear			Inspect and replace as necessary			Inspect and replace as necessary
Wheel Rotation			Inspect & clean, adjust, lubricate, replace as necessary			
Wheel Wear						Inspect & clean, adjust, lubricate, replace as necessary
Sprocket Rotation/Wear			Inspect & clean, adjust, replace as necessary			Inspect & clean, adjust, lubricate, replace as necessary
Cracks and Shocks to the Frame or Bracket				Inspect & clean, adjust, replace as necessary		Inspect & clean, adjust, replace as necessary
REPLACE WORN OR BROKEN PARTS						

Replacement Procedures

Tracks

WARNING

1. The ATV must be immobilized, in 2WD mode, in neutral, and the engine shut off and cooled.
2. Make sure the ATV is secured in place by a system dedicated to this use (jack stands and hoist) and that it lies on or is fastened to areas that are not likely to break, bend, or slip. A hydraulic jack is not safe, nor is a log. The ATV must not be able to move.
3. Always wear safety glasses during installation, adjustment, or repair.
4. Do not over-tighten cap screws or nuts. Some components may be subject to deformation. If cap screws are too tight, safety could be compromised.
5. Please read warnings and instructions and be sure that you understand them.

■NOTE: This procedure is appropriate for all four sprockets and main axles.

1. Lift the ATV; then loosen the tensioner nut.

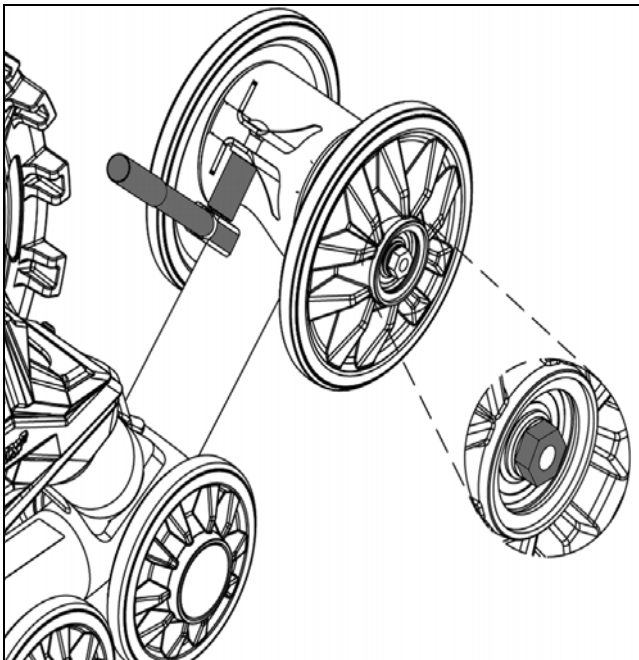

TT-027

3. Remove the cap of the wheel tensioner using a flathead screwdriver.
4. Provide some free-play to the track by rotating the tensioner cylinder.

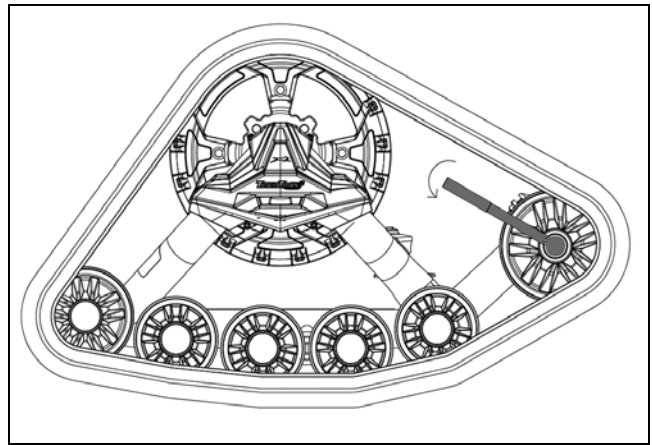

TT-026

5. Remove the track by grasping it with both hands at the level of the sprocket and pulling it outwards while lifting.
6. Place the new track under the frame wheels making sure the track is in position toward the front of the ATV.

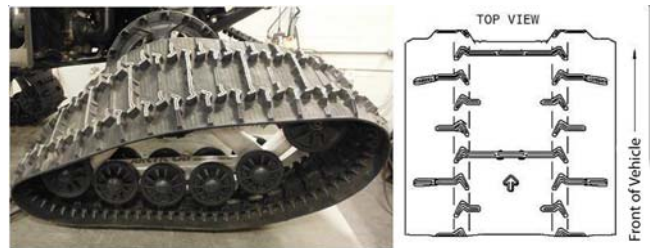

TT-050

7. Position the track so that the wheels are in the wheel path of the track.

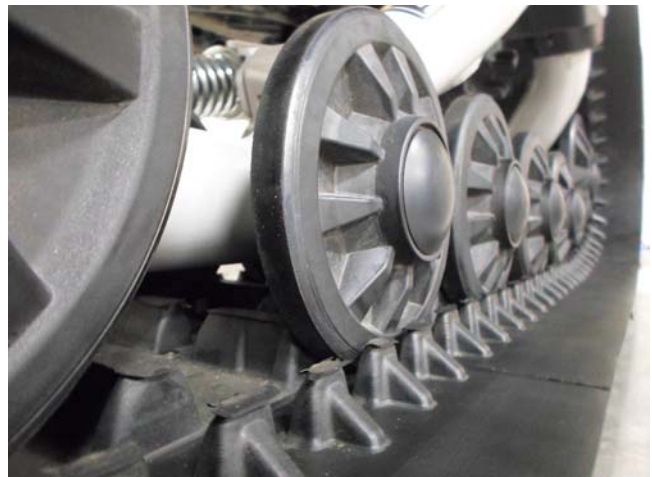

TT-051

8. Install the ATV on the track ensuring the wheels remain on the wheel path.
9. Pass the hanging portion of the track upwards over the sprocket. Ensure the tensioner is in its rear most position to facilitate installation. Be careful that track teeth fit between sprocket teeth.
10. Check track tension (see Adjusting Components - Track Tension).

Sprocket

Follow steps 1-5 of Tracks in this section; then do the following:

1. Remove the M12 nut from the rod end of the anti-rotation arm.

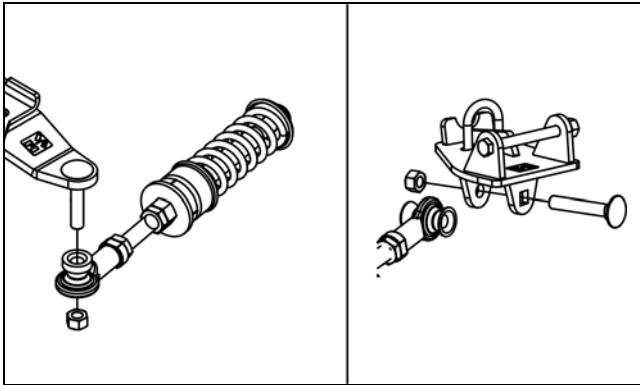

TT-022

2. Remove the wheel nuts of the ATV in order to free the frame.
3. Set the track assembly on a flat, clean surface; then stand the frame on its wheels.
4. Remove the four M8 screws securing the sprocket on the main axle with a 13-mm wrench and a 13-mm socket.
5. Remove the used sprocket and discard it appropriately (recyclable).
6. Install the new sprocket and secure it with the four M8 screws. Tighten to 25 ft-lb.
7. Re-install the frame on the ATV.
8. Tighten the M12 nut on the rod to 61 ft-lb.
9. Proceed to step 6 of Tracks in this section.

Plastic Guard

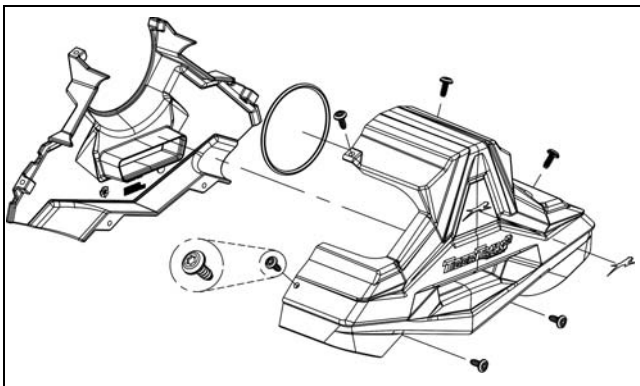

TT-023

1. Remove the torx screws securing the plastic guard; then remove the guard.
2. Clean the inside of the steel bearing cage with a dry cloth.

3. Grease the O-ring of the new plastic guard with good quality grease.



TT-052

4. Install new plastic guard using six torx head screws. Tighten securely.

Main Axle or Main Axle Bearings

The main axle is set up using a press. You must contact an authorized Arctic Cat dealer for this operation.

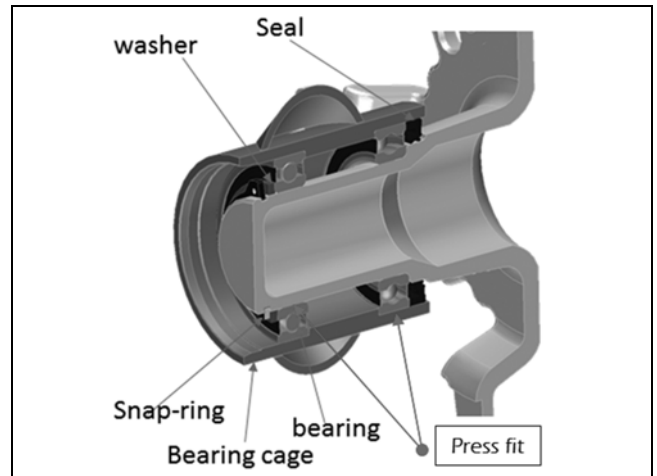

TT-036

Wheel

Follow steps 1-4 of Tracks in this section; then do the following:

1. Using a flathead screwdriver, remove the wheel cap.
2. Loosen the M10 x 25 mm cap screw while holding the wheel to the frame (for the tensioner wheel, there is no screw, but a snap ring to be replaced).

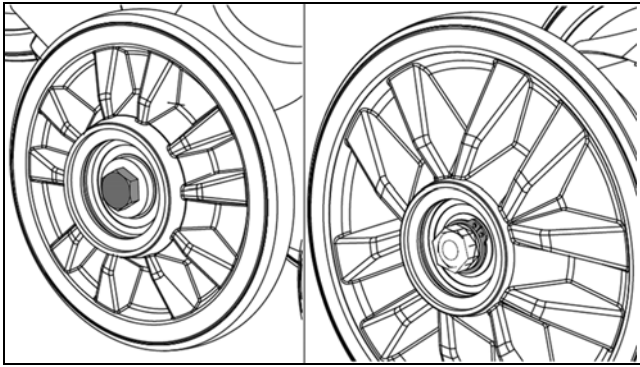

TT-020

3. Remove the wheel. Check if the rear washer remained on the shaft; otherwise, recover it from the wheel.
4. Push down on the track to provide sufficient clearance between the wheel and track in order to replace the wheel.
5. Secure the wheel using an M10 x 25 mm cap screw or snap ring and tighten to 34 ft-lb. Adjust track tension (see Adjusting Components - Track Tension).

Tensioner Cylinder

Follow steps 1-5 of Tracks in this section; then follow steps 1-2 of Wheel in this section.

1. Remove the tightening screw M10 from the tensioner.
2. Separate the jaws using a crescent wrench; then remove the tensioner cylinder by slipping through the jaws.



TT-053

3. Place the new component in the same way while ensuring the side of the shaft with the hexagonal drive is not on the side of the ATV.
4. Partially tighten the tensioner using the M10 screw.
5. Follow steps 4-5 of Wheel in this section; then install the tracks and adjust track tension (see Adjusting Components - Track Tension).

Tandem Assembly Nylon Bushing

Follow steps 1-5 of Tracks in this section; then follow steps 1-3 of Wheel in this section.

1. Remove the plastic plug on the tandem assembly.
2. Holding the screw with an allen wrench, unscrew the other side using an allen wrench.



TT-054

3. Remove the tandem assembly, central axle, and the O-ring.
4. Pull out the nylon bushing.
5. Install the new nylon bushing (it may be necessary to use a plastic hammer).
6. Insert grease inside nylon bushing.
7. Make sure the bolt and central axle is clean and dry; then add red Loctite #271.
8. Install the components using the same order as disassembly.

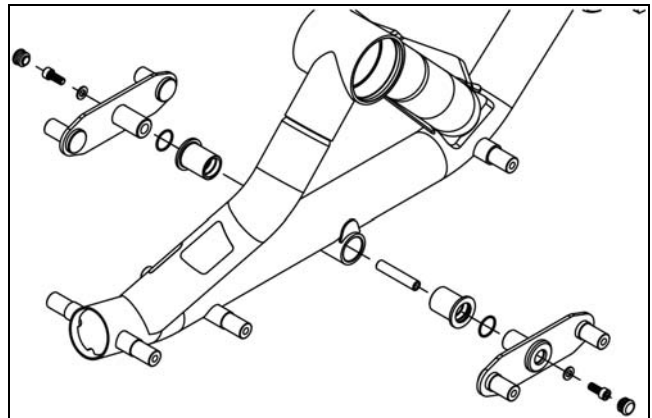

TT-017

9. Tighten the socket head bolt to 17 ft-lb.
10. Verify the tandem assembly moves freely without excessive free-play.
11. Install the plastic plug.
12. Follow steps 4-5 of Wheel in this section; then install the tracks and adjust track tension (see Adjusting Components - Track Tension).

Preparation for Storage

1. Thoroughly clean off any dirt prior to storage.
2. Store on a level surface to ensure stability.
3. Do not put additional load on the ATV.
4. Store ATV in clean, dry place.
5. Do not store near heat source.
6. Consult maintenance schedule.

Preparation after Storage

1. Verify all fasteners are secure.
2. Verify the main axles and wheels spin freely.
3. Verify the anti-rotational devices work properly and are adjusted correctly.
4. Verify track tension.
5. Consult the maintenance schedule.

CAUTION

If stored for more than four consecutive weeks in a wet place, verify bearings and seals are not damaged.

EC DECLARATION OF CONFORMITY

We,

Soucy International Inc.
5450 ST-ROCK-S, CP400
Drummondville, QC, J2B6W3, Canada,

Declare That The Products: «TIGER TRAX 2» 2540189 AND 2540191, Fulfil All The Relevant Provisions Of The Directive: 2006/42/EC in Drummondville On May 16, 2013

Owner/Warranty Registration

Write the appropriate information in the spaces below. Please keep this information for your own records.

Name _____

Address _____

City/Town _____

State/Prov _____

Zip/Postal Code _____

Serial # _____

■NOTE: Serial number is located on inside of front right track kit assembly.

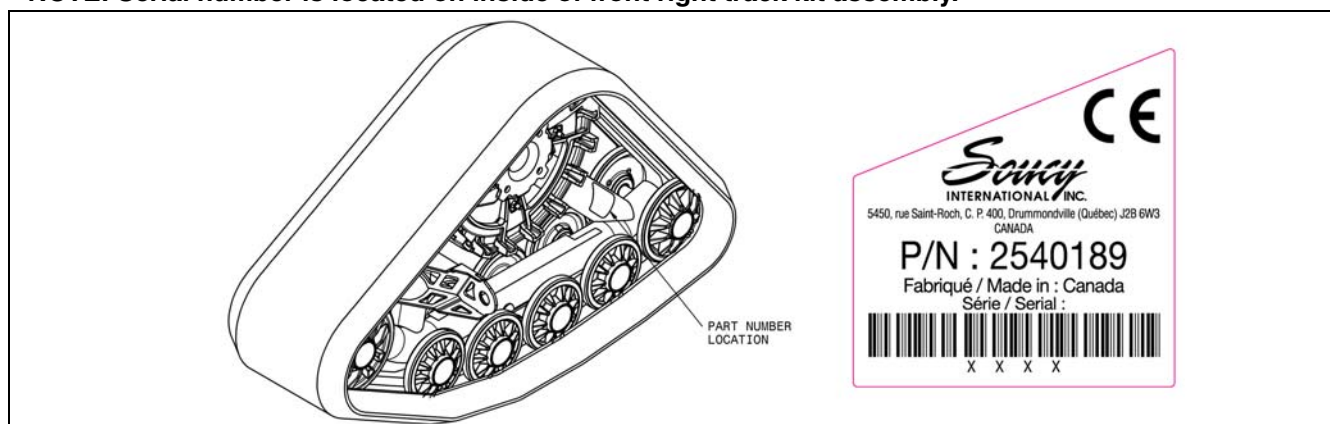

Date Sold _____

Delivery Checklist:

- ☐ Review the Arctic Cat Limited Warranty with customer.
- ☐ Review with the customer the Operation, Installation Instructions, and Adjusting Components sections.
- ☐ Review with the customer the Break-In and Maintenance section.
- ☐ Review with the customer the daily and periodic inspections.
- ☐ Review with the customer the Service Parts section.

Prior to delivery to the customer, do the following:

- ☐ Record the Serial Number for the Arctic Cat Product.
- ☐ Complete this form which is also available on Cat Tracker and fax form to 218-681-9859.
- ☐ Make a copy of the registration form for the customer.
- ☐ Give the customer the Operator's Manual and encourage the customer to read it.

Date Delivered _____

Dealer Signature _____

Customer Signature _____

Date _____